

# AQUEA

## V-LOCK LID

- ▶ SEAMLESS ACCESS TO SKIMMER BOXES
- ▶ LOCKABLE LID FOR ULTIMATE SAFETY
- ▶ MODELS FOR INLAYS 8 ~ 60mm THICK
- ▶ NO ELECTRICAL BONDING REQUIRED



**GOOD  
DESIGN  
AWARD®  
WINNER**



**GOLD AWARD  
PRODUCT OF  
THE YEAR  
VICTORIA 2023**



**GOLD AWARD  
NEW PRODUCT  
AWARD  
VICTORIA 2023**



**HIGHLY COMMENDED  
NEW PRODUCT  
AWARD  
QUEENSLAND 2023**



**HIGHLY COMMENDED  
NEW PRODUCT  
AWARD  
NSW 2023**



**FINALIST  
PRODUCT OF  
THE YEAR  
NATIONAL 2023**



**FINALIST  
NEW PRODUCT  
AWARD  
NATIONAL 2023**

THE LOCKABLE CONCEALED LID

# V-LOCK SETS THE NEW STANDARD FOR SAFE & CONCEALED SKIMMER BOX ACCESS

V-LOCK Lids offer safe and concealed access to pool skimmers, protecting pool users from potential injury and setting a new benchmark for compliance to Australian Safety Standard AS1926.3

Manufactured from reinforced engineering polymer, V-LOCK lids provide exceptional strength, rigidity, and weather resistance without the need for electrical bonding or unsightly tea-staining.

V-LOCK's flush-fitting lids are easy to install and seamlessly blend into pool surroundings, ensuring a flawless finish every time. Ideal for both new pools and renovations, V-LOCK's straightforward on-site installation and range of models make it the perfect solution for tile, stone, concrete and timber pool decks.



## AUSTRALIAN DESIGNED FOR ALL POOLS AND ENVIRONMENTS

### ROBUST AND SECURE

V-LOCK's metal diecast key won't bend or break, providing ergonomic & safe lifting of lids.

### VERSATILE RANGE

Ideal for new builds or retrofits, V-LOCK lids come in a range of depths to suit any pool deck material. Dual-key kits adapt seamlessly to poured concrete or paver installations.

### SMART DESIGN

Quick and easy installation for all inlay types, including tile, stone, paver, timber, and concrete. All kits come with templates and construction caps. Dual-key kits also include anchors and construction spacers for poured concrete.

### SAFE AND SECURE

V-LOCK's locking mechanism and perimeter venting ensures compliance with AS1926.3, for all inlay types and thicknesses, in single and dual-key models.

### NON-CONDUCTIVE POLYMER

V-LOCK's reinforced, UV-stable engineering polymer provides superior strength, rigidity, and weatherability with no electrical bonding or unsightly tea-staining.

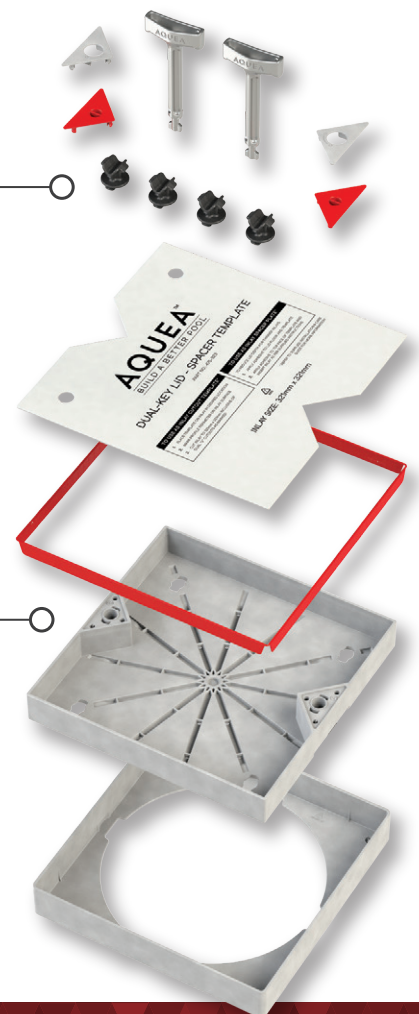
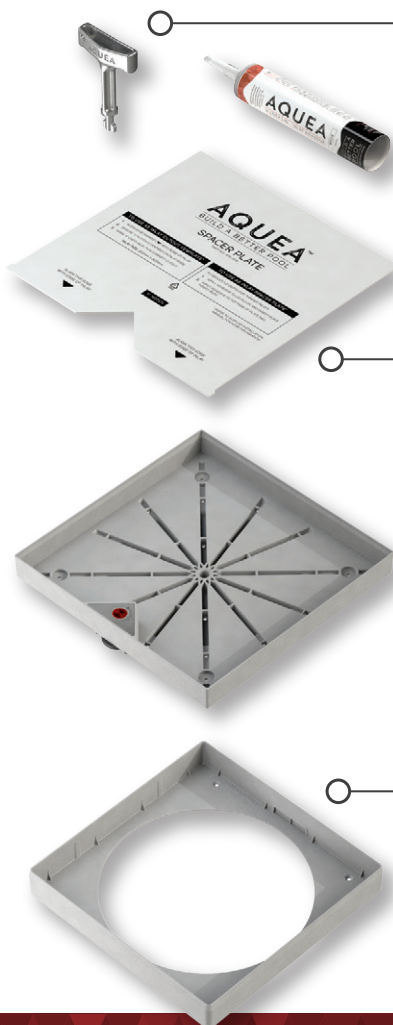

SINGLE KEY LID KIT

DUAL KEY LID KIT

# THE V-LOCK RANGE HAS THE PERFECT SOLUTION FOR YOUR POOL

## THE V-LOCK RANGE



SINGLE KEY

**S-SERIES**

S-SERIES Lids offer discreet access for small applications like hydrostatic stand pipes. Using the same V-LOCK Key as V-SERIES lids they comply with AS1926.3 for superior safety.

### Applications include:

- ▶ Hydrostatic stand pipes
- ▶ Plumbing inspection points
- ▶ Small pool deck equipment



SINGLE KEY

**M-SERIES and V-SERIES**

M-SERIES provides a concealed access solution for compact pool skimmers, while V-SERIES lids suit standard skimmers and pool deck equipment. The V-LOCK locking mechanism ensures full AS1926.3 compliance across all inlay materials and thicknesses, delivering ultimate pool safety.

### Applications include:

- ▶ Compact and standard Australian skimmers
- ▶ Auto levellers / fillers
- ▶ In-floor cleaning leaf canisters

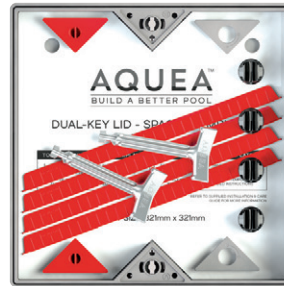

DUAL KEY



SINGLE KEY

**VS COMBO KITS**

VS Combo Kits combine a V-SERIES and S-SERIES lid with a V-LOCK Key & adhesive. A simple, cost-effective solution for multi-lid installs such as fibreglass pools.

### Benefits include:

- ▶ Ideal for fibreglass pools
- ▶ Suitable for all pool types
- ▶ Convenient & cost effective

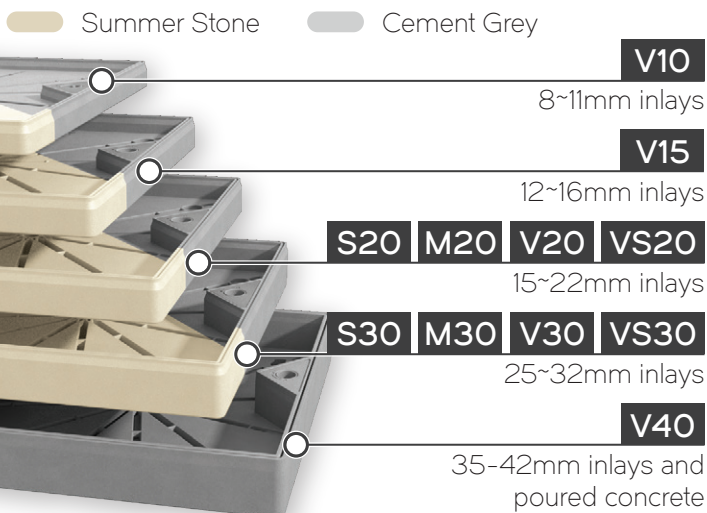

## DESIGNED FOR EVERY POOL DECK

V-LOCK V10 and V15 are the only polymer lids designed for thin tile or stone, featuring a unique rigid lid design that prevents cracking. S/M/V20 models suit popular 20mm thick finishes, while S/M/V30 models suit 30mm inlays.

Single key models are available in Summer Stone and Cement Grey colours to complement warm, neutral and cool-toned finishes. Decking inlays can be screwed directly into the polymer lid to prevent lifting caused by moisture.

M60 and V40 lids suit poured concrete and paver inlays and include construction caps and anchors for easy install. Clip-in trims provide a scratch-free finish every time.



Suitable for use with all inlay types



Polymer construction & superior lockable design



Twist & lift action for easy access to skimmer boxes



Durable & ergonomic metal lid key

# SPECIFICATIONS

	S-SERIES	M-SERIES	V-SERIES	VS COMBO KITS
<b>COLOUR</b>	<ul style="list-style-type: none"> <li>Cement Grey</li> <li>Summer Stone</li> </ul>	<ul style="list-style-type: none"> <li>Cement Grey</li> <li>Summer Stone<sup>1</sup></li> </ul>	<ul style="list-style-type: none"> <li>Cement Grey</li> <li>Summer Stone<sup>1</sup></li> </ul>	<ul style="list-style-type: none"> <li>Cement Grey</li> <li>Summer Stone</li> </ul>
<b>POOL TYPE</b>	Suits all pool types	Suits all pool types	Suits all pool types	Suits all pool types
<b>WARRANTY</b>	5 Years	5 Years	5 Years	5 Years
<b>LOCK TYPE</b>	Single Key	Single Key/Dual Key	Single Key/Dual Key	Single Key
<b>INLAY TYPE</b>	Tile/Stone Timber/Composite Deck	Tile/Stone/Decking <sup>1</sup> Paver/Poured Concrete <sup>2</sup>	Tile/Stone/Decking <sup>1</sup> Paver/Poured Concrete <sup>2</sup>	Tile/Stone Timber/Composite Deck
<b>KIT CONTENTS</b>	<ul style="list-style-type: none"> <li>Outer Frame</li> <li>Lid Assembly</li> <li>Spacer Plate</li> <li>Lid Key</li> <li>Grouting Plugs</li> </ul>	<ul style="list-style-type: none"> <li>Outer Frame</li> <li>Lid Assembly</li> <li>Trim Plate/s</li> <li>Paver Template</li> <li>Lid Key/s</li> <li>Construction Cap/s</li> <li>Adhesive &amp; Nozzle<sup>1</sup></li> </ul> <p><b>M60 (Additional parts)</b></p> <ul style="list-style-type: none"> <li>Concrete Anchors</li> <li>Construction Spacers</li> </ul>	<ul style="list-style-type: none"> <li>Outer Frame</li> <li>Lid Assembly</li> <li>Spacer Plate</li> <li>Lid Key/s</li> <li>Grouting Plugs<sup>1</sup></li> <li>Adhesive &amp; Nozzle<sup>1</sup></li> </ul> <p><b>V40 (Additional parts)</b></p> <ul style="list-style-type: none"> <li>Construction Caps</li> <li>Trim Plates</li> <li>Concrete Anchors</li> <li>Construction Spacers</li> </ul>	<ul style="list-style-type: none"> <li>V-SERIES Outer Frame, Lid and Spacer Plate</li> <li>S-SERIES Outer Frame, Lid and Spacer Plate</li> <li>Lid Key</li> <li>Adhesive &amp; Nozzle</li> <li>Grouting Plugs</li> </ul>

<sup>1</sup> Single Key only <sup>2</sup> Dual Key only

INLAY THICKNESS	MODEL	PART #	MODEL	PART #	MODEL	PART #	MODEL	PART #
8~11 mm	-	-	-	-	<b>V10</b>	<ul style="list-style-type: none"> <li>475-201</li> <li>475-201-SR</li> </ul>	-	-
12~16 mm	-	-	-	-	<b>V15</b>	<ul style="list-style-type: none"> <li>475-203</li> <li>475-203-SR</li> </ul>	-	-
15~22 mm	<b>S20</b>	<ul style="list-style-type: none"> <li>475-219</li> <li>475-219-SR</li> </ul>	<b>M20</b>	<ul style="list-style-type: none"> <li>475-227</li> <li>475-227-SR</li> </ul>	<b>V20</b>	<ul style="list-style-type: none"> <li>475-205</li> <li>475-205-SR</li> </ul>	<b>VS20</b>	<ul style="list-style-type: none"> <li>475-237</li> <li>475-237-SR</li> </ul>
25~32 mm	<b>S30</b>	<ul style="list-style-type: none"> <li>475-221</li> <li>475-221-SR</li> </ul>	<b>M30</b>	<ul style="list-style-type: none"> <li>475-229</li> <li>475-229-SR</li> </ul>	<b>V30</b>	<ul style="list-style-type: none"> <li>475-207</li> <li>475-207-SR</li> </ul>	<b>VS30</b>	<ul style="list-style-type: none"> <li>475-238</li> <li>475-238-SR</li> </ul>
35~42 mm	-	-	-	-	<b>V40</b>	<ul style="list-style-type: none"> <li>475-231</li> <li>N/A</li> </ul>	-	-
54~60 mm	-	-	<b>M60</b>	<ul style="list-style-type: none"> <li>475-223</li> <li>N/A</li> </ul>	-	-	-	-

## KEY DIMENSIONS

\*Equal dimension for width and length | All dimensions in mm | Tolerance +/- 10mm | Specifications subject to change without notice.

S-SERIES	V-SERIES   M-SERIES - SINGLE KEY		V-SERIES   M-SERIES - DUAL KEY	
<p><b>A - FRAME*</b> <b>B - INLAY*</b> FRAME DEPTH S20: 37 S30: 47 <b>Ø C - OPENING</b></p>	<p><b>A - FRAME*</b> <b>B - INLAY*</b> FRAME DEPTH V10: 26 V15: 32 V20: 37 V30: 47 M20: 33 M30: 43 <b>Ø C - OPENING</b></p>		<p><b>A - FRAME*</b> <b>B - INLAY*</b> FRAME DEPTH V40: 54 M60: 73 <b>Ø C - OPENING</b></p>	
<p><b>S-SERIES</b></p> <p><b>A 206   B 185   C 167</b></p>	<p><b>M-SERIES</b></p> <p><b>A 305   B 281   C 254</b></p>	<p><b>V-SERIES</b></p> <p><b>A 342   B 322   C 293</b></p>	<p><b>M-SERIES</b></p> <p><b>A 305   B 281   C 254</b></p>	<p><b>V-SERIES</b></p> <p><b>A 342   B 321   C 293</b></p>

AQUEA® and V-LOCK® are registered trademarks of AQUEA Pty. Ltd.

The contents of this document are the exclusive copyright of AQUEA® and may not be reproduced without written permission. © 2026

Whilst every care was taken in preparation of this document, AQUEA® accepts no responsibility for the accuracy of the information supplied.

475-849-05

# AQUEA

HELLO@AQUEA.COM.AU

WWW.AQUEA.COM.AU

0481 875 870



BUILD A  
BETTER  
POOL

# AQUEA | V-LOCK LID

## THE LOCKABLE CONCEALED ACCESS LID FOR SKIMMER BOXES

V-LOCK's unique locking system provides superior safety for pool owners, and simplifies Australian standards compliance for pool builders.

The flush-fitting lid is easy to install and blends into the pool surrounds. The V-LOCK range includes models to suit tile, stone and timber deck finishes.

V-LOCK's advanced engineering polymer delivers superior strength, rigidity and weatherability without the need for electrical bonding.

### KEY FEATURES:

- ▼ Lockable lid for superior safety
- ▼ Seamless access to skimmers and pool deck equipment
- ▼ Reinforced polymer construction avoids electrical bonding
- ▼ Versatile range for tile, stone and timber inlays

### V-LOCK LID - V-SERIES RANGE

MODEL	INLAY THICKNESS	INTERNAL LID DEPTH	PART NO.
V10	8~11 mm	12 mm	● 475-201 ● 475-201-SR
V15	12 ~16 mm	18 mm	● 475-203 ● 475-203-SR
V20	15~22 mm	23 mm	● 475-205 ● 475-205-SR
V30	25~32 mm	33 mm	● 475-207 ● 475-207-SR
S20	15~22 mm	23 mm	● 475-219 ● 475-219-SR
S30	25~32 mm	33 mm	● 475-221 ● 475-221-SR

### SPECIFICATIONS

<b>DESCRIPTION</b>	V-LOCK Lid Kit
<b>COLOURS</b>	<span style="display: inline-block; width: 15px; height: 10px; background-color: #cccccc; margin-right: 5px;"></span> Cement Grey <span style="display: inline-block; width: 15px; height: 10px; background-color: #d4c08c; margin-right: 5px;"></span> Summer Stone
<b>POOL TYPE</b>	Suits all pool types



### WANT MORE INFORMATION?

Scan this code to watch our series of helpful V-LOCK Lid videos.



Specifications subject to change without notice.

### KEY DIMENSIONS

All dimensions in mm Tolerance +/- 1.0mm

#### S-SERIES

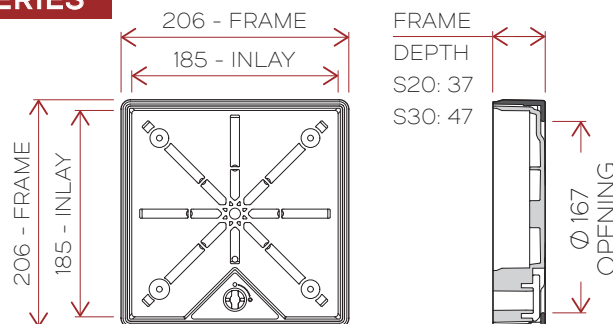

#### V-SERIES

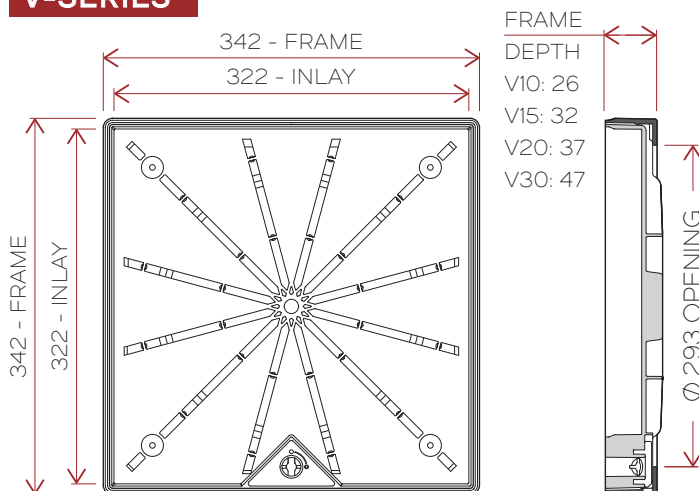

AQUEA® and V-LOCK® are registered trademarks of AQUEA Pty. Ltd. The contents of this document are the exclusive copyright of AQUEA® and may not be reproduced without written permission. © 2026 Whilst every care was taken in preparation of this document, AQUEA® accepts no responsibility for the accuracy of the information supplied.

475-825-04

# AQUEA

HELLO@AQUEA.COM.AU

WWW.AQUEA.COM.AU

0481 875 870



BUILD A  
BETTER  
POOL

# AQUEA | V-LOCK V40

FOR POURED CONCRETE AND PAVER INLAYS 35~42mm THICK

The V40 lid's ergonomic dual-key design facilitates safe lifting of lid by users, and the dual-locking action securely retains lid to ensure compliance with Australian safety standards.

Construction caps and spacers simplify concrete pouring, and lock trims clip into place for a perfect 'scratch-free' finish after grinding or grouting.

V-LOCK lids' reinforced polymer will not corrode, rust or 'tea-stain' like many marine-grade stainless steel products in pool water environments, eliminating the risk of unsightly staining of surrounding pool deck and reducing ongoing maintenance.

V-LOCK lids non-conductive polymer construction delivers superior strength, rigidity and weatherability **free from tea-staining and electrical bonding!**

## KEY FEATURES:

- ▼ Lockable lid complies with safety standards
- ▼ 100% non-conductive with no electrical bonding
- ▼ Free from corrosion, rust and tea-staining
- ▼ Smart design simplifies set-up & installation

## SPECIFICATIONS

<b>DESCRIPTION</b>	V-LOCK V40 Lid Kit
<b>COLOUR</b>	■ Cement Grey
<b>POOL CONSTRUCTION</b>	Suits all pool types
<b>KIT CONTENTS</b>	Outer Frame Lid Assembly      Lid Keys (x2) Spacer Plate      Trim Plates (x2) Construction Caps (x2) Construction Spacers (x4)



### WANT MORE INFORMATION?

Scan this code to watch our series of helpful V-LOCK Lid videos.



V40's smart design can be configured for either poured concrete or thick paver inlays

## KEY DIMENSIONS

All dimensions in mm

Tolerance +/- 1.0mm

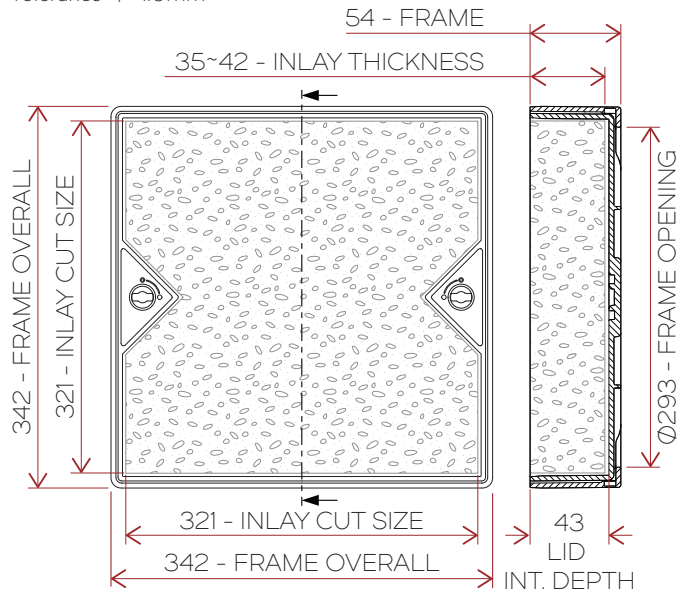

Specifications subject to change without notice.

AQUEA® and V-LOCK® are registered trademarks of AQUEA Pty. Ltd. The contents of this document are the exclusive copyright of AQUEA® and may not be reproduced without written permission. © 2026 Whilst every care was taken in preparation of this document, AQUEA® accepts no responsibility for the accuracy of the information supplied.

475-8015-03

# AQUEA

HELLO@AQUEA.COM.AU

WWW.AQUEA.COM.AU

0481 875 870



BUILD A  
BETTER  
POOL

# AQUEA | V-LOCK M-SERIES

## THE LOCKABLE CONCEALED LID FOR COMPACT SKIMMERS

V-LOCK's unique locking system provides superior safety for pool owners, and simplifies Australian standards compliance for pool builders.

The flush-fitting lid is easy to install and blends into the pool surrounds. The V-LOCK M-SERIES is suitable for porcelain, stone and timber deck finishes.

V-LOCK's reinforced polymer will not corrode, rust or 'tea-stain' like many marine-grade stainless steel products in pool water environments, eliminating the risk of unsightly staining of surrounding pool deck and reducing ongoing maintenance.

V-LOCK lids non-conductive polymer construction delivers superior strength, rigidity and weatherability **free from tea-staining and electrical bonding!**

### KEY FEATURES:

- ▼ Lockable lid complies with AS1926.3
- ▼ 100% non-conductive with no electrical bonding
- ▼ Free from corrosion, rust and tea-staining
- ▼ Smart design simplifies set-up & installation

### V-LOCK LID - M-SERIES RANGE

MODEL	INLAY THICKNESS	INTERNAL LID DEPTH	PART NO.
M20	15~22 mm	23 mm	● 475-227
			● 475-227-SR
M30	25~32 mm	33 mm	● 475-229
			● 475-229-SR

### SPECIFICATIONS

<b>DESCRIPTION</b>	V-LOCK Lid Kit
<b>COLOUR</b>	<span style="display: inline-block; width: 15px; height: 10px; background-color: #ccc; border: 1px solid #000; margin-right: 5px;"></span> Cement Grey <span style="display: inline-block; width: 15px; height: 10px; background-color: #d9c48c; border: 1px solid #000; margin-right: 5px;"></span> Summer Stone
<b>POOL TYPE</b>	Suits all pool types



Tolerance: +/- 1.0mm

### KEY DIMENSIONS

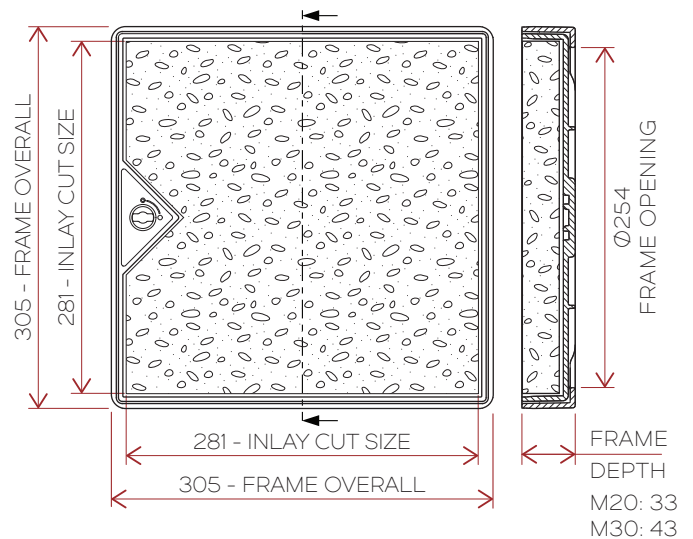

Specifications subject to change without notice.



### WANT MORE INFORMATION?

Scan this code to watch our series of helpful V-LOCK Lid videos.

AQUEA® and V-LOCK® are registered trademarks of AQUEA Pty. Ltd. The contents of this document are the exclusive copyright of AQUEA® and may not be reproduced without written permission. © 2026  
Whilst every care was taken in preparation of this document, AQUEA® accepts no responsibility for the accuracy of the information supplied.

475-8023-04

# AQUEA

HELLO@AQUEA.COM.AU

WWW.AQUEA.COM.AU

0481 875 870



## BUILD A BETTER POOL

# AQUEA | V-LOCK M60

## FOR POURED CONCRETE AND PAVER INLAYS

The M60 lid's ergonomic dual-key design facilitates safe lifting of lid by users, and the dual-locking action securely retains lid to ensure compliance with Australian safety standards.

Construction caps and spacers simplify concrete pouring, and lock trims clip into place for a perfect 'scratch-free' finish after grinding or grouting.

V-LOCK lids' reinforced polymer will not corrode, rust or 'tea-stain' like many marine-grade stainless steel products in pool water environments, eliminating the risk of unsightly staining of surrounding pool deck and reducing ongoing maintenance.

V-LOCK lids non-conductive polymer construction delivers superior strength, rigidity and weatherability **free from tea-staining and electrical bonding!**

### KEY FEATURES:

- ▼ Lockable lid complies with safety standards
- ▼ 100% non-conductive with no electrical bonding
- ▼ Free from corrosion, rust and tea-staining
- ▼ Smart design simplifies set-up & installation

### SPECIFICATIONS

DESCRIPTION	V-LOCK M60 Lid Kit
COLOUR	■ Cement Grey
POOL CONSTRUCTION	Suits all pool types
KIT CONTENTS	Outer Frame Lid Assembly Paver Template Construction Caps (x2) Construction Spacers (x4) Lid Keys (x2) Trim Plates (x2)

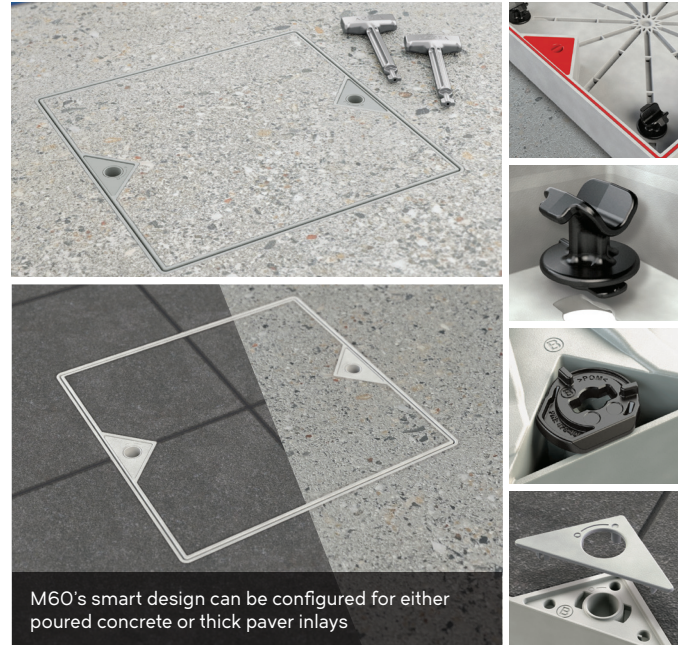

M60's smart design can be configured for either poured concrete or thick paver inlays

Tolerance: +/- 1.0mm

### DIMENSIONS

Specifications subject to change without notice.

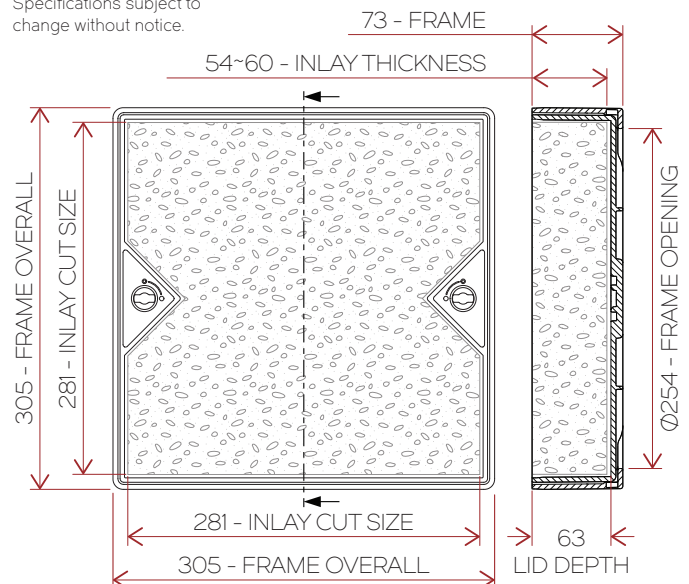

### WANT MORE INFORMATION?

Scan this code to watch our series of helpful V-LOCK Lid videos.

AQUEA® and V-LOCK® are registered trademarks of AQUEA Pty. Ltd.

The contents of this document are the exclusive copyright of AQUEA® and may not be reproduced without written permission. © 2026

Whilst every care was taken in preparation of this document, AQUEA® accepts no responsibility for the accuracy of the information supplied.

475-8022-03

# AQUEA

HELLO@AQUEA.COM.AU

WWW.AQUEA.COM.AU

0481 875 870



## BUILD A BETTER POOL

# AQUEA

## V-LOCK LID

### INSTALLATION & CARE GUIDE

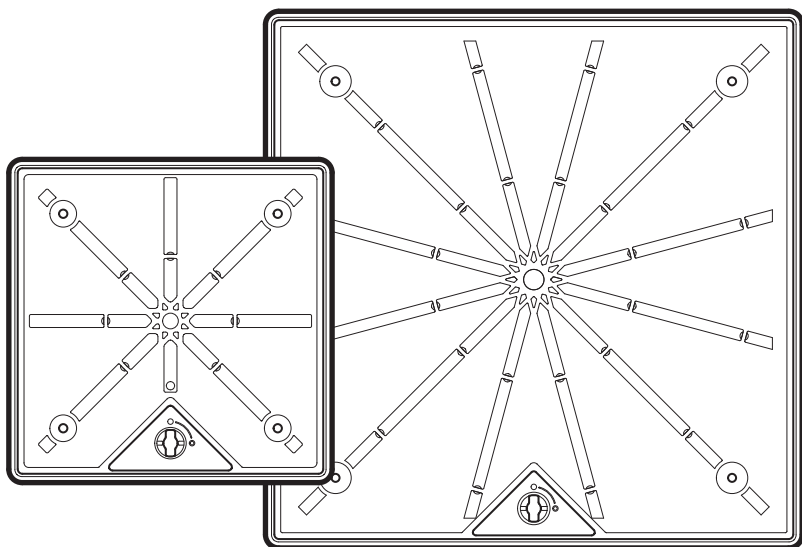

S-SERIES PART NO. 475-219 | 475-221

M-SERIES PART NO. 475-227 | 475-229

VS COMBO KIT PART NO. 475-237 | 475-238

V-SERIES PART NO. 475-201 | 475-203 | 475-205 | 475-207

#### ⚠ NOTE:

1. READ THIS DOCUMENT PRIOR TO INSTALLATION. IMPROPER INSTALLATION WILL VOID WARRANTY.
2. PRODUCT ONLY TO BE INSTALLED & SERVICED BY A SUITABLY QUALIFIED PROFESSIONAL.
3. DO NOT USE ACID/CHEMICAL WASHES. DISCOLORATION MAY OCCUR AND WILL VOID WARRANTY.
4. INSTALLER TO ENSURE INSTALLATION MEETS ALL APPLICABLE ENGINEERING & REGULATORY REQUIREMENTS.
5. DO NOT CARRY LID WITH KEY.
6. ALWAYS REMOVE KEY FROM LID ONCE LOCKED. KEEP KEY OUT OF REACH OF CHILDREN.
7. THIS MANUAL CONTAINS IMPORTANT INFORMATION. ONCE INSTALLATION IS COMPLETE INSTALLER MUST PROVIDE THIS MANUAL TO OWNER/OPERATOR TO STORE IN A SAFE PLACE.

# **IMPORTANT - PLEASE NOTE:**

1. SEE "GENERAL USAGE" SECTION FOR INSTRUCTIONS REGARDING CORRECT OPERATION OF LID (SEE PAGE 9)
2. DO NOT CARRY LID WITH LID KEY AS THIS MAY RESULT IN INJURY OR DAMAGE
3. DO NOT USE HARSH CHEMICALS, ACIDS OR ABRASIVE MATERIALS TO CLEAN LID, OUTER FRAME OR LID KEY
4. KEEP LID KEY OUT OF REACH OF CHILDREN. LID SHOULD ONLY BE OPERATED BY A CAPABLE ADULT
5. ENSURE FINGERS & TOES ARE CLEAR OF LID WHEN LOWERING TO AVOID INJURY
6. DO NOT OPEN SKIMMER WHILE PUMP IS OPERATING
7. DO NOT LEAVE LID KEY IN LID WHEN NOT IN USE. STORE LID KEY IN A SAFE PLACE
8. FOR SMOOTH AND RELIABLE OPERATION, KEEP YOUR V-LOCK LID FREE OF DIRT, SAND, LEAF MATTER AND DEBRIS



## **SAFETY FIRST**

PLEASE ENSURE SUITABLE PERSONAL PROTECTION EQUIPMENT AND SAFE WORK PRACTICES ARE USED.

## **ALL V-LOCK LIDS ARE COVERED BY A 5 YEAR WARRANTY**

See "WARRANTY POLICY" for further information

Ref: 475-818-06

Registered Design. Specifications subject to change without notice.

AQUEA® is a trademark of AQUEA Pty. Ltd.

The contents of this manual are the exclusive copyright of AQUEA® and may not be reproduced without written permission. © 2025

Whilst every care was taken in preparation of this document, AQUEA® accepts no responsibility for the accuracy of the information supplied.

# KIT CONTENTS

**NOTE:** VS20 & VS30 Combo Kits include a single Lid Key

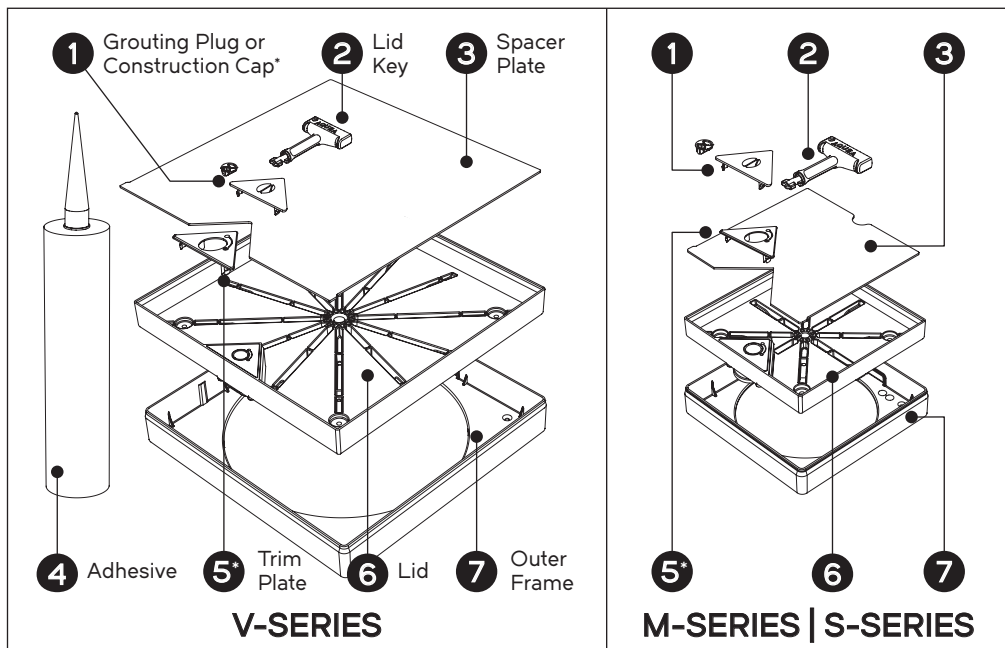

## KEY DIMENSIONS

\*Included in kits with colour matched polymer trim plate only

MODEL		S20	S30	M20	M30	V10	V15	V20	V30
OUTER FRAME	Overall Depth	37.0	47.0	33.0	43.0	26.0	32.0	37.0	47.0
	Overall Width	206.0		305.0		342.0			
	Overall Length	206.0		305.0		342.0			
LID	Internal Lid Depth	23.0	33.0	23.0	33.0	12.0	18.0	23.0	33.0
	Inlay Thickness Range	15~22	25~32	15~22	25~32	8~11	12~16	15~22	25~32
	Overall Inlay Width	185.0		281.0		322.0			
	Overall Inlay Length	185.0		281.0		322.0			
All dimensions in millimeters. Tolerance +/- 1.0mm									

## FEEDBACK & SUGGESTIONS

We are continually looking for ways to improve and expand our product range. Please contact us at [hello@aquea.com.au](mailto:hello@aquea.com.au) if you have any feedback or suggestions!

# OUTER FRAME PREPARATION - STONE/TILE

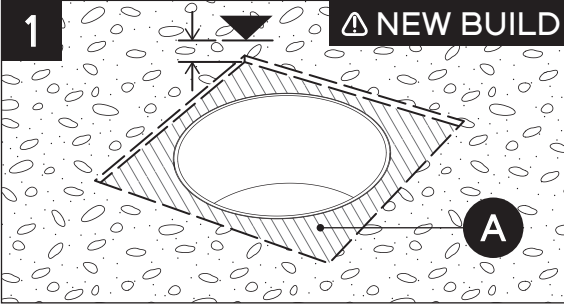

## NEW BUILD

- Check & confirm finished height of stone/tile.
- Check & confirm overall height of V-LOCK model to be installed (See Page 2).
- Prepare a level bed slightly larger than overall size of Outer Frame including mortar bed allowance (A).

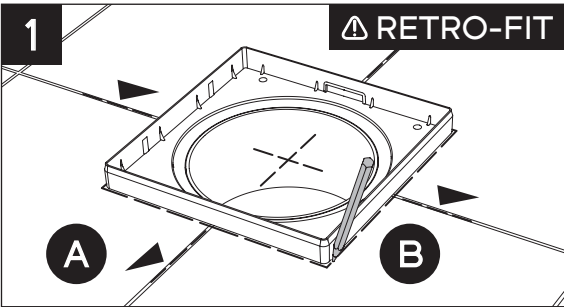

## RETRO-FIT

- Align & centre Outer Frame over existing skimmer box opening (A).
- Mark perimeter of Outer Frame on surrounding stone/tile (B).

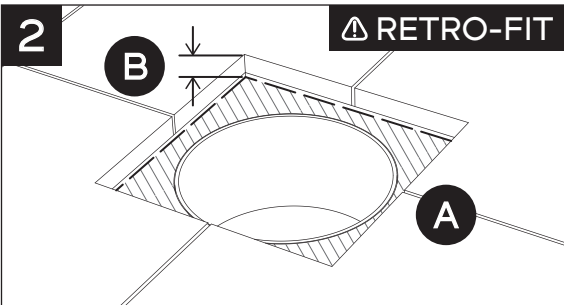

To create recess for Outer Frame:

- Carefully cut existing tile/stone to create recess for Outer Frame (A).
- Remove debris to a depth suitable for overall height of V-LOCK model to be installed (See Page 2) plus mortar bed allowance (B).

# OUTER FRAME INSTALLATION - STONE/TILE

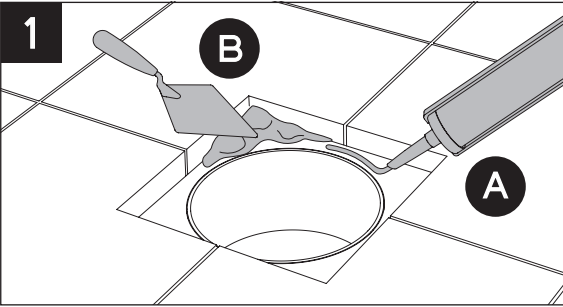

To prepare for Outer Frame install:

- Using an appropriate adhesive, apply a generous, even bead across mounting surface surrounding skimmer opening (A).  
**OR**
- Using appropriate mortar mix, insert mortar into recess surrounding skimmer opening (B).

**IMMEDIATELY REMOVE ANY MORTAR OR ADHESIVE THAT FALLS INTO SKIMMER**

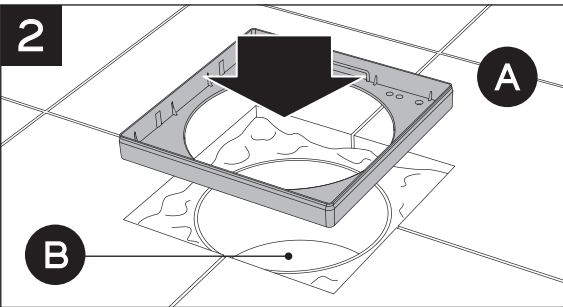

To install Outer Frame:

- Place Outer Frame on mortar or adhesive bed. Outer Frame must be fully supported (A).
- Ensure top rim of Outer Frame is flush with finished stone/paver surface.
- Remove any excess mortar/adhesive and ensure skimmer opening is fully accessible through Outer Frame (B).

**IMMEDIATELY REMOVE ANY MORTAR OR ADHESIVE THAT FALLS INTO SKIMMER**

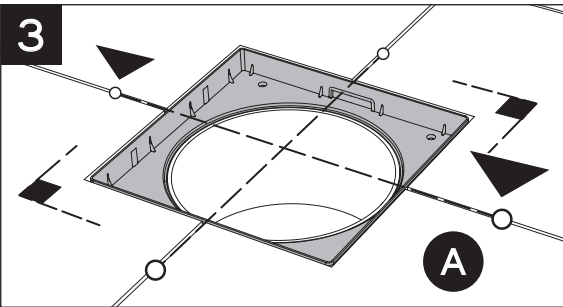

**BEFORE MORTAR OR ADHESIVE IS CURED**

To install Outer Frame:

- Adjust as required to ensure Outer Frame is level, square and top rim is flush with surrounding surface (A).

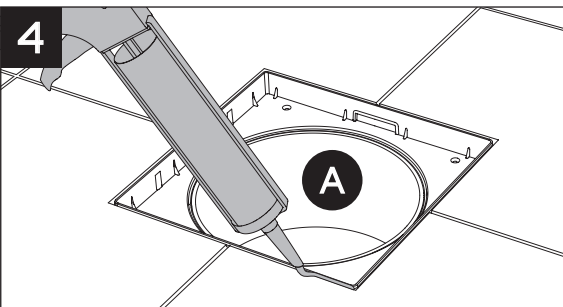

**AFTER MORTAR OR ADHESIVE IS CURED**

To finish Outer Frame:

- **PREFERRED** - Fill gap surrounding Outer Frame using a suitable expansion joint gap filler (A).
- **ALTERNATE** - Apply grout around Outer Frame perimeter using preferred mortar/grout compound\*.

\* Using rigid grout or mortar may result in gaps/cracking appearing over time due to natural expansion & contraction.

# OUTER FRAME INSTALLATION - DECKING

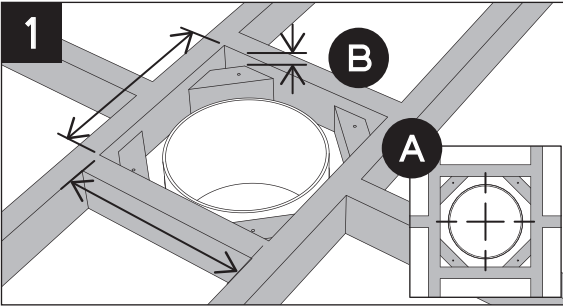

To prepare sub-frame:

- Construct square opening in sub-frame slightly larger than Outer Frame, centred over skimmer box opening (A).
- Fix corner gussets to sub-frame opening. Ensure gussets are recessed so top surface of Outer Frame rim is flush with finished decking level (B).

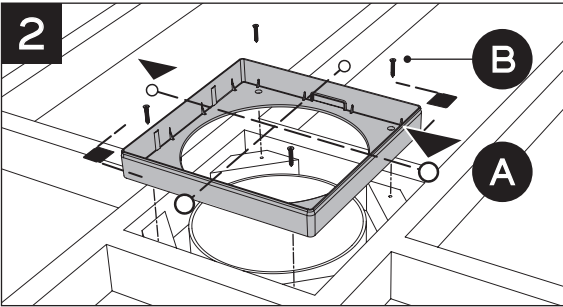

To install Outer Frame:

- Adjust as required to ensure Outer Frame is square, level and centred on skimmer box opening (A).
- Attach Outer Frame to sub-frame with suitable fasteners through pre-moulded mounting holes (B).

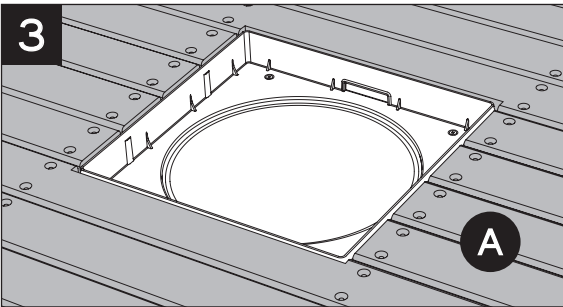

Applying decking:

- Lay decking around Outer Frame leaving a small clearance gap (A).

**HINT:** For a seamless installation, cut boards spanning Outer Frame so that a section equal to width of Lid is removed. These pieces can be used to create a perfectly grain-matched Lid inlay.

# LID INLAY INSTALLATION - STONE/TILE

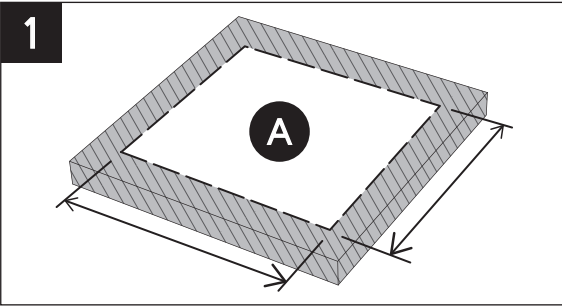

To cut inlay material to size:

- Place inlay material in desired layout on a flat surface.
- Carefully cut to correct size to suit V-LOCK Lid (A). (See Page 2)

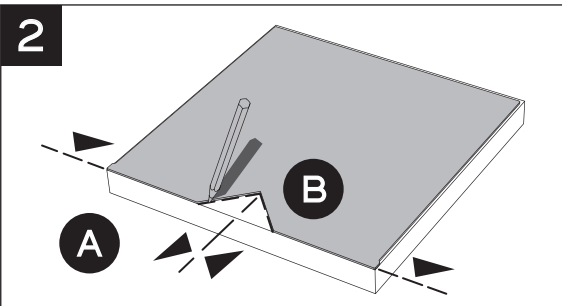

To mark V-notch cut-out:

- Place inlay material with preferred surface facing upwards.
- Position Spacer Plate on inlay material.
- Align & centre V-notch edge of Spacer Plate with selected edge of inlay (A).
- Mark V-notch cut-out profile (B).

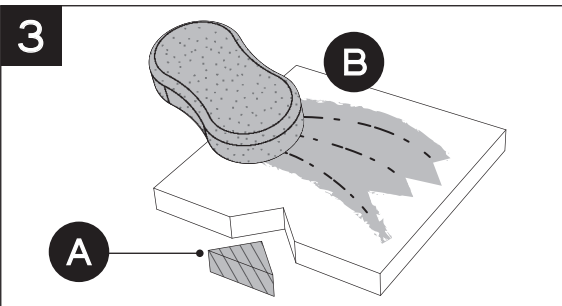

Prepare inlay for installation:

- Carefully cut and remove V-notch material from inlay (A).
- Thoroughly clean and dry inlay to maximise adhesive bond strength (B).

**ENSURE INLAY IS FREE FROM DUST, OIL, DEBRIS AND COMPLETELY DRY BEFORE CONTINUING.**

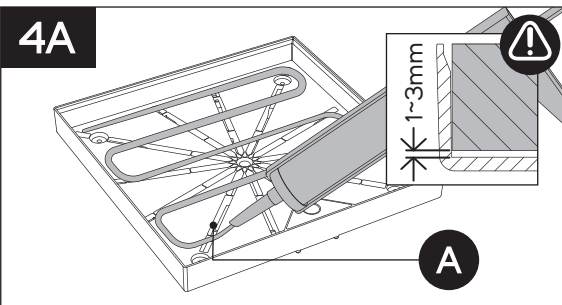

**FOR INLAYS 1~3mm THINNER THAN INTERNAL LID DEPTH**

To apply adhesive :

- Insert Adhesive into caulking gun & cut nozzle to provide a minimum 6mm wide bead.
- Apply a generous, even bead across entire internal surface of Lid (A).

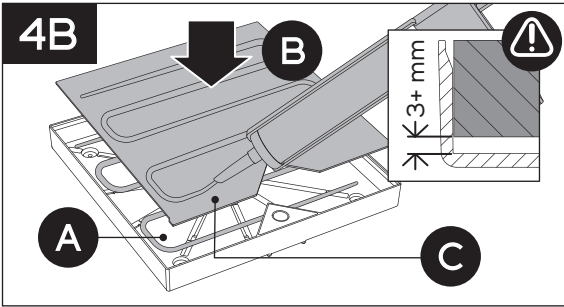

**FOR INLAYS MORE THAN 3 mm THINNER THAN INTERNAL LID DEPTH**

To apply adhesive :

- Insert Adhesive into caulking gun & cut nozzle to provide a minimum 6mm wide bead.
- Apply a generous, even bead across entire internal surface of Lid (A).
- Insert Spacer Plate into Lid (B).
- Apply generous, even bead across entire top surface of Spacer Plate (C).

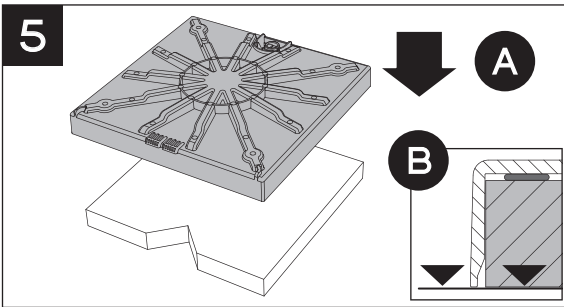

To install inlay material into Lid:

- Place inlay material face-down on a flat work surface.
- Invert Lid and lower onto inlay material (A) until Lid outer rim is touching work surface (B).

**LEAVE FOR APPROXIMATELY 15 MINUTES TO ALLOW ADHESIVE TO PARTIALLY CURE.**

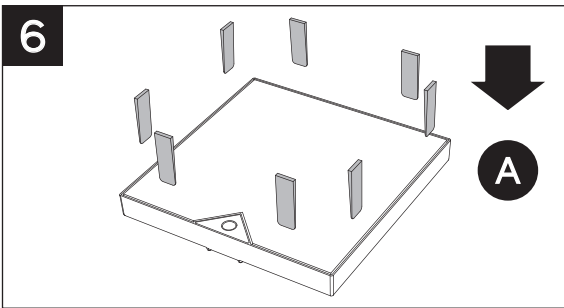

To position inlay material:

- Carefully flip Lid over and check inlay is centred for consistent grout line thickness.
- If required insert tiling wedges or similar to adjust inlay to correct position (A).

**LEAVE FOR APPROXIMATELY 24 HOURS TO ALLOW ADHESIVE TO CURE FULLY.**

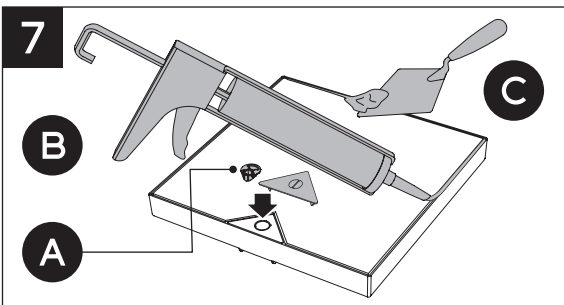

Finishing Lid:

- Insert Grouting Plug or Construction Cap to protect key opening (A).
- **PREFERRED** - Fill gap surrounding inlay using an appropriate expansion joint gap filler (B).
- **ALTERNATE** - Apply preferred mortar or grouting compound (C)\*.

**DO NOT USE HARSH CHEMICALS, ACID WASHES OR ABRASIVE MATERIALS TO CLEAN LID**

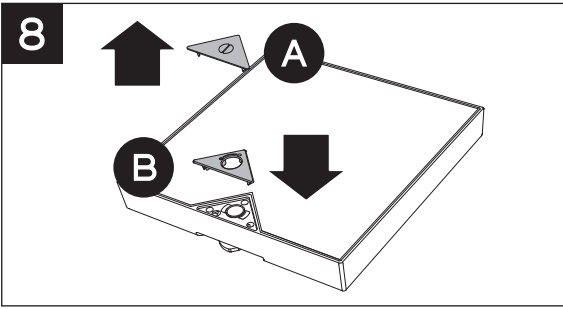

To assemble polymer Trim Plate (if required):

- Remove red Construction Cap. (A)
- Ensure key opening and surrounding recess is clean & free from debris.
- Carefully clip Trim Plate into recess. (B)

## LID INLAY INSTALLATION - DECKING

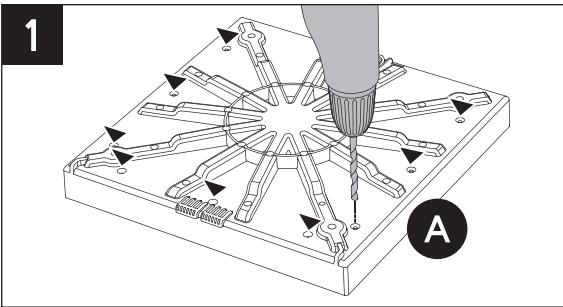

To prepare Lid for mounting battens:

- Invert Lid and select preferred mounting points for correct batten orientation.
- Drill holes in pre-moulded locations to suit preferred fasteners and batten direction (A).

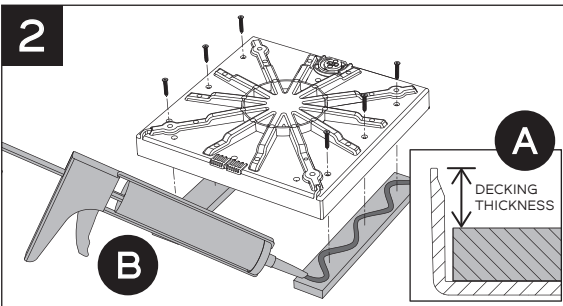

To attach battens:

- Pre-cut two timber battens ensuring batten thickness equals internal Lid depth minus decking thickness (A).
- Fasten battens into Lid using a combination of fasteners and appropriate adhesive (B).

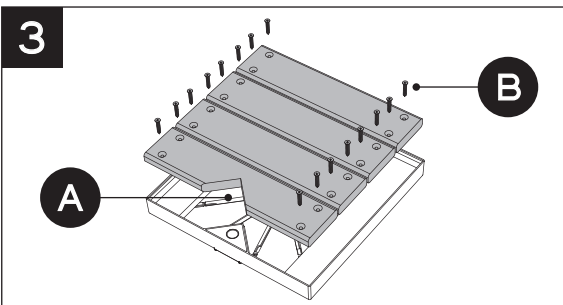

To install decking inlay:

- Pre-cut decking to fit Lid. Use Spacer Plate as template for V-notch if required (A).
- Attach decking to battens with appropriate timber fasteners (B) or adhesive.

**ENSURE FASTENER LENGTH IS MINIMUM 2.0mm LESS THAN LID INTERNAL DEPTH.**

# GENERAL USAGE

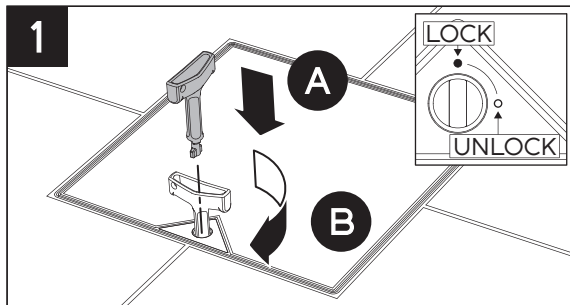

## TO OPEN LID

To unlock Lid:

- Insert Lid Key into lock as shown (A).
- Rotate Key 90 degrees clockwise to unlock position. Lid Key is now captive in Lid.

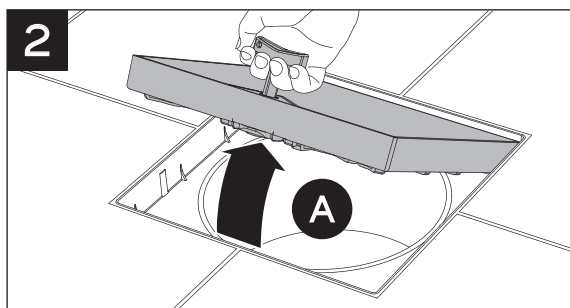

To remove Lid:

- Using Lid Key as a handle lift Lid upwards (A), then grab edges of Lid by hands and remove from Outer Frame.

**DO NOT CARRY LID WITH LID KEY.**

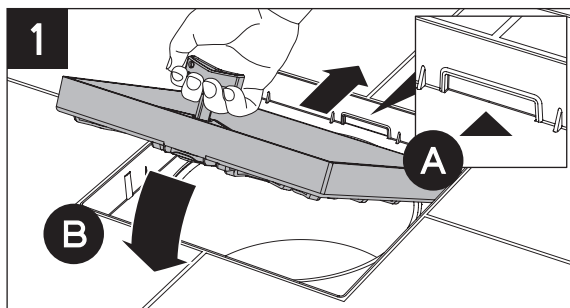

## TO CLOSE LID

To close Lid:

- Angle and slide Lid's rear edge towards large pocket in Outer Frame (A).
- Engage hooks on rear edge of Lid into pocket and carefully lower Lid into Outer Frame (B).

**LID MUST BE INSERTED IN CORRECT ORIENTATION TO LOCK.**

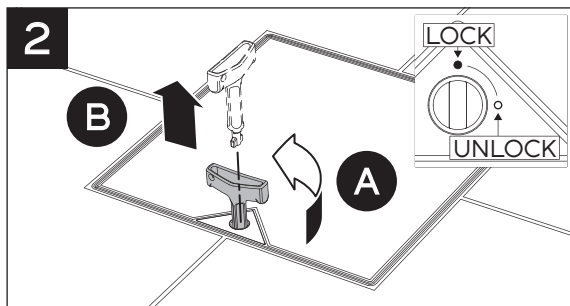

To lock Lid:

- Rotate Lid Key 90 degrees anti-clockwise to locked position, ensuring latch engages correctly in outer frame (A).
- Remove Lid Key vertically from lock and store in safe place (B).

**KEEP LID KEY OUT OF REACH OF CHILDREN.**

# WARRANTY POLICY

AQUEA Pty. Ltd. warrants that, subject to the exclusions and limitations below, its products will be free from defects in materials and workmanship for a minimum period of 12 MONTHS from the date of purchase. All warranty periods commence on the date of purchase by the customer and are only valid in original country of purchase. The provisions of this warranty are not transferable.

If a defect appears in any Product supplied by AQUEA before the end of the Warranty Period due solely to defective materials or workmanship, AQUEA will in its sole discretion, and subject to these terms and conditions, either:

- a) repair the Product or the defective part of the Product free of charge; or
- b) have the Product or the defective part of the Product repaired by a qualified repairer free of charge; or
- c) replace the Product.

AQUEA at its sole discretion may replace defective parts of the Products with parts and components of similar quality, grade and composition where an identical part or component is not available. Refurbished parts may be used to repair the Products.

All repairs are to be carried out by AQUEA or its authorised repairer only. This warranty does not cover any costs related to travel, removal or re-installation associated with repair or replacement of the Product.

## TO MAKE A WARRANTY CLAIM

To claim under this warranty the customer should immediately cease use of the Product once alleged defect is identified, and contact AQUEA within 30 days.

To make a claim the customer must:

1. Provide the following information:

- (a) proof of purchase disclosing date and place of purchase;
- (b) full details of the alleged defect; and
- (c) any other appropriate documentation.

2. The customer must make the Product or site available to AQUEA or its authorised repair agent for inspection and testing. If such inspection and testing finds no defect in the Product, the customer must pay AQUEA's usual costs of service work and testing.

3. The customer agrees to pay AQUEA's usual charges (including any service fee) for any goods or services provided by AQUEA not covered by this product warranty.

4. The customer is responsible for the cost of transport and all insurance of the Product to and from AQUEA or its authorised repair agent.

## WARRANTY CONDITIONS

This warranty only applies where the following conditions are met:

1. The customer complies with the following general maintenance requirements:

- (a) The Product is maintained free from general debris or foreign matter.
- (b) The Product is maintained and serviced regularly (at least every 12 months) by a suitably qualified professional.
- (c) Where applicable, the Product is replaced at specified intervals as outlined in product literature by AQUEA.

2. Where applicable, Product has been used in pool or spa water which:

- (a) is maintained within a pH range of 7.2-7.6, and chemically balanced as per accepted industry standards.
- (b) is regularly (at least once a month) treated with a sanitising system in compliance with applicable regulatory recommendations or regulations.
- (c) has not exceeded 40 degrees Celsius in temperature.
- (d) has not been exposed to freezing conditions.

## WARRANTY EXCLUSIONS

This warranty will not apply where:

- (a) the Product has not been installed in accordance with the installation instructions provided with the Product, any statutory requirements and these terms and conditions;
- (b) the Product has not been installed by a suitably qualified professional trained in the installation and operation of such products with more than 12 months industry experience;
- (c) a failure to observe and comply with the instructions supplied with product for the proper use, service or maintenance of the Product has occurred;
- (d) the Product has been used for a purpose other than that for which it was designed and manufactured;
- (e) removal or installation of the Product has contributed to, or resulted in, the defect or damage;
- (f) the Product has been repaired, altered or modified by someone other than AQUEA or its authorised agent;
- (g) substitute or replacement parts not provided by AQUEA have been used;
- (h) the defect has arisen due to abuse, misuse, neglect, or accident;
- (i) the Product has been subject to abnormal conditions, including environment, temperature, water, fire or other acts of nature;
- (j) the Product has been subject to abnormal corrosive conditions or abrasive chemicals;
- (k) the defect is the result of corrosion or normal wear and tear;
- (l) the defect is the result of insect and/or vermin infestation;
- (m) concrete, cement, render, pebbles or other pool surface finishes contribute to the defect, or inhibit proper function of the Product;
- (n) the damage occurred in transit;
- (o) after testing and inspection AQUEA cannot establish any fault in the Product;
- (p) the Product has been used in a commercial application;
- (q) the Product has not been supplied by AQUEA;
- (r) the defect is related to any cause other than a defect in the materials or workmanship of the Product.

## LIMITATIONS

AQUEA makes no express warranties or representations other than set out in this warranty.

Except to the extent required by the Australian Consumer Law, the repair or replacement of the Product or part of the Product is the absolute limit of AQUEA's liability under this express warranty.

To the extent permitted by law, AQUEA will not be liable for:

- (a) Damage to any other property caused by defect in the Product.
- (b) Any indirect, special or consequential loss arising from or related to defects in the Product, including, but not limited to, loss of time, loss of use of the product, loss of business opportunity, loss of profits, loss of revenue, loss of goodwill, or inconvenience.
- (c) Any other damage as a result of weather or natural disaster.
- (d) Any claim against the customer by other parties.

Our goods come with guarantees that cannot be excluded under the Australian Consumer Law. You are entitled to a replacement or refund for a major failure and for compensation for any other reasonably foreseeable loss or damage. You are also entitled to have the goods repaired or replaced if the goods fail to be of acceptable quality and the failure does not amount to a major failure.

The benefits of this warranty are in addition to any rights and remedies imposed by Australian State and Federal legislation that cannot be excluded. Nothing in this warranty is to be interpreted as excluding, restricting or modifying any State or Federal legislation applicable to the supply of goods and services which cannot be excluded, restricted or modified.

## CONTACT

For warranty claims visit [www.aquea.com.au](http://www.aquea.com.au) or contact AQUEA using details overleaf.

---

BUILD A  
BETTER  
POOL

---

**AQUEA**

---

[WWW.AQUEA.COM.AU](http://WWW.AQUEA.COM.AU)

**AQUEA** Pty. Ltd.  
U12/22-24 REDLAND DRIVE, MITCHAM, VICTORIA 3132.  
**SALES & SUPPORT ENQUIRIES - HELLO@AQUEA.COM.AU**  
**PHONE - 0481 875 870**

# AQUEA

## V-LOCK LID

### INSTALLATION & CARE GUIDE

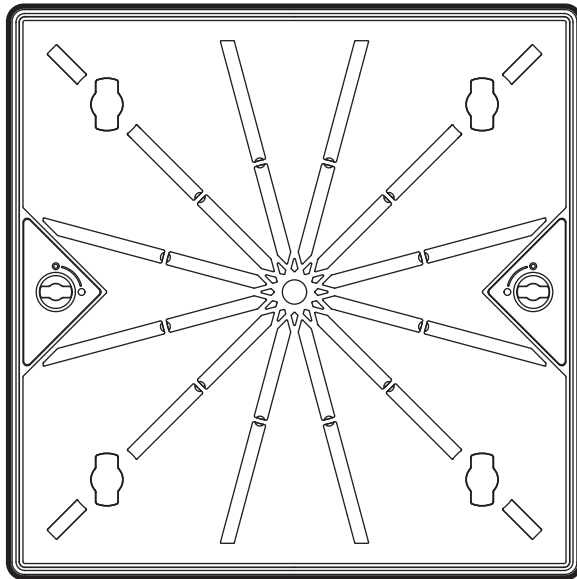

# V40

V-SERIES V40 - PART NO. 475-231

#### NOTE:

1. READ THIS DOCUMENT PRIOR TO INSTALLATION. IMPROPER INSTALLATION WILL VOID WARRANTY.
2. PRODUCT ONLY TO BE INSTALLED & SERVICED BY A SUITABLY QUALIFIED PROFESSIONAL.
3. DO NOT USE ACID/CHEMICAL WASHES. DISCOLORATION MAY OCCUR AND WILL VOID WARRANTY.
4. INSTALLER TO ENSURE INSTALLATION MEETS ALL APPLICABLE ENGINEERING & REGULATORY REQUIREMENTS.
5. DO NOT CARRY LID WITH KEYS.
6. ALWAYS REMOVE KEYS FROM LID ONCE LOCKED. KEEP KEYS OUT OF REACH OF CHILDREN.
7. THIS MANUAL CONTAINS IMPORTANT INFORMATION. ONCE INSTALLATION IS COMPLETE INSTALLER MUST PROVIDE THIS MANUAL TO OWNER/OPERATOR TO STORE IN A SAFE PLACE.



## IMPORTANT - PLEASE NOTE



1. SEE "GENERAL USAGE" SECTION FOR INSTRUCTIONS REGARDING CORRECT OPERATION OF LID (SEE PAGE 11)
2. DO NOT CARRY LID WITH LID KEYS AS THIS MAY RESULT IN INJURY OR DAMAGE
3. DO NOT USE HARSH CHEMICALS, ACIDS OR ABRASIVE MATERIALS TO CLEAN LID, OUTER FRAME OR LID KEY
4. KEEP LID KEYS OUT OF REACH OF CHILDREN. LID SHOULD ONLY BE OPERATED BY A CAPABLE ADULT
5. ENSURE FINGERS & TOES ARE CLEAR OF LID WHEN LOWERING TO AVOID INJURY
6. DO NOT OPEN SKIMMER WHILE PUMP IS OPERATING
7. DO NOT LEAVE KEYS IN LID WHEN NOT IN USE. STORE KEYS IN A SAFE PLACE
8. FOR SMOOTH AND RELIABLE OPERATION, KEEP YOUR V-LOCK LID FREE OF DIRT, SAND, LEAF MATTER AND DEBRIS



## SAFETY FIRST



**PLEASE ENSURE SUITABLE PERSONAL PROTECTION EQUIPMENT AND SAFE WORK PRACTICES ARE USED.**

## ALL V-LOCK LIDS ARE COVERED BY A 5 YEAR WARRANTY

See "WARRANTY POLICY" for further information

AUSTRALIAN DESIGNS NO. - 202310380, 202310379, 202310378

The contents of this manual are the exclusive copyright of AQUEA® and may not be reproduced without written permission. © 2024. Whilst every care was taken in preparation of this document, AQUEA® accepts no responsibility for the accuracy of the information supplied. Specifications subject to change without notice.

Ref: 475-893-02

# CONTENTS

	<b>PAGE</b>
PARTS LIST .....	2
<b>INSTALLATION OPTIONS</b>	
STONE OR PAVER INSTALLATION .....	3
POURED CONCRETE INSTALLATION .....	8
GENERAL USAGE .....	11
PRODUCT DIMENSIONS .....	12
WARRANTY POLICY .....	13

---

## PARTS LIST

# V-LOCK V40 LID KIT

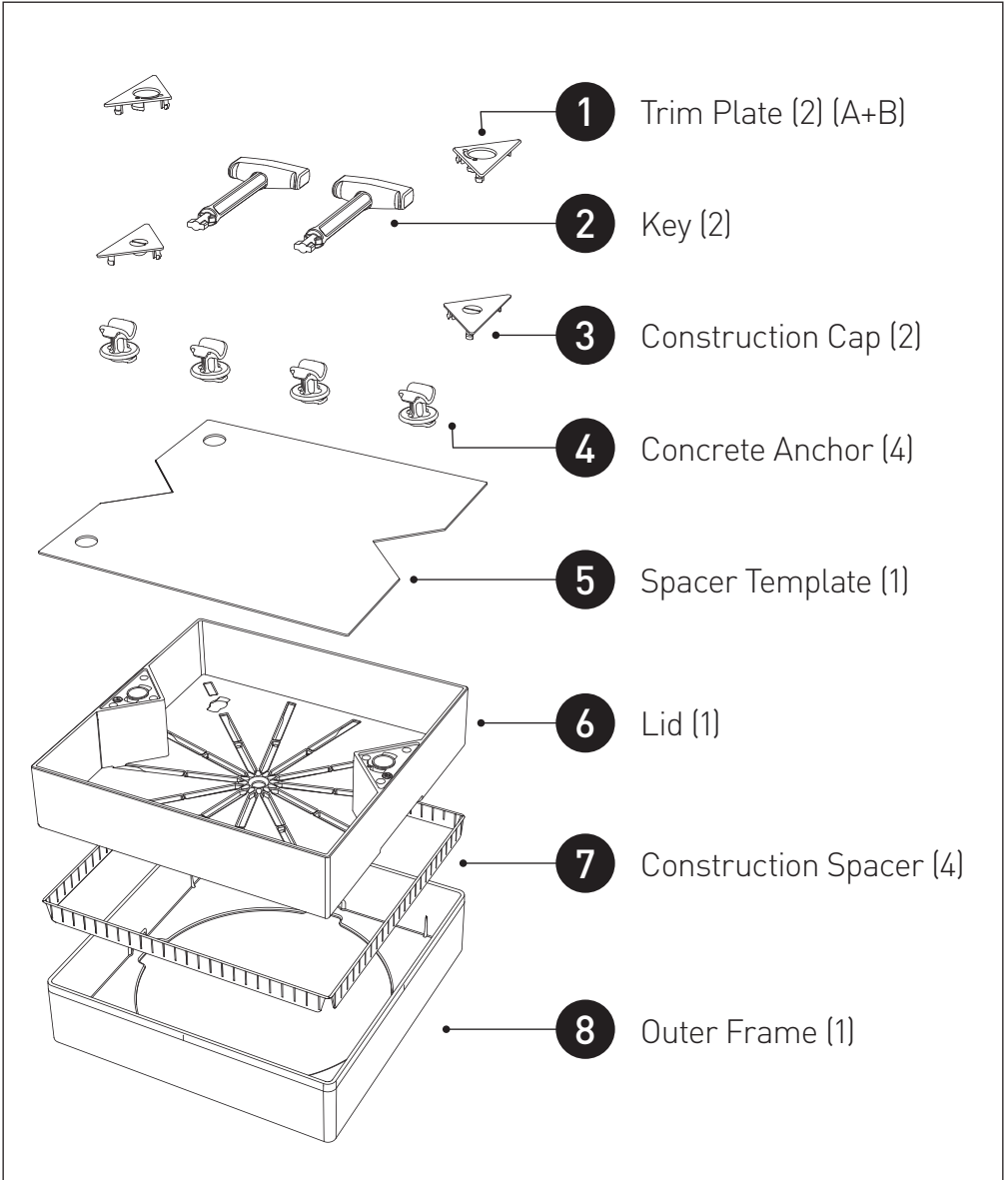

# STONE OR PAVER INSTALLATION



## BEFORE COMMENCING INSTALLATION

1. Remove lid supplied with skimmer box
2. **RECOMMENDED** - Using appropriate tape or equivalent, temporarily cover top opening of skimmer box to prevent concrete or debris falling into skimmer during installation. Remove once installation is complete.
3. Installation instructions assume a solid mounting substrate suitable for securely attaching components with adhesive. (e.g. concrete)
4. Check all kit components in "PARTS LIST" are present (See Page 2)
5. Remove Lid from Outer Frame using Keys (See GENERAL USAGE)

## NEW BUILD

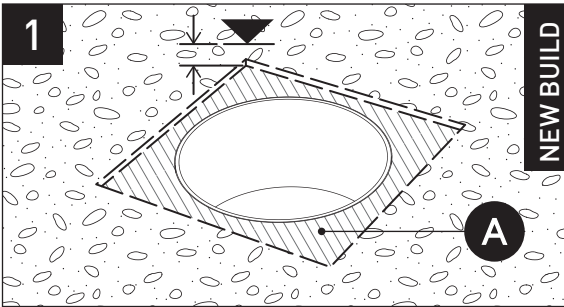

To correctly position Outer Frame:

- Determine finished height of installed stone/pavers.
- Confirm overall height of V-LOCK Lid (See Page 12).
- Prepare a level surface slightly larger than Outer Frame to suit finished paver height including allowance for mortar or adhesive under Outer Frame (A).

## RETRO-FIT

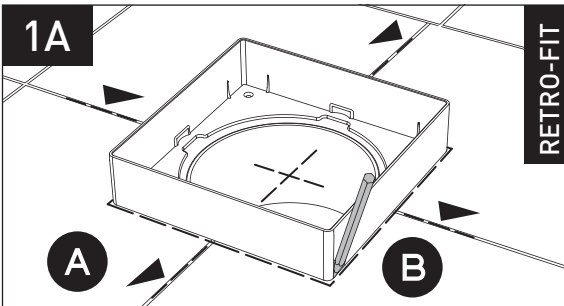

To correctly position Outer Frame:

- Align Outer Frame to existing skimmer box opening (A).
- Mark perimeter of Outer Frame on surrounding stone/pavers (B).

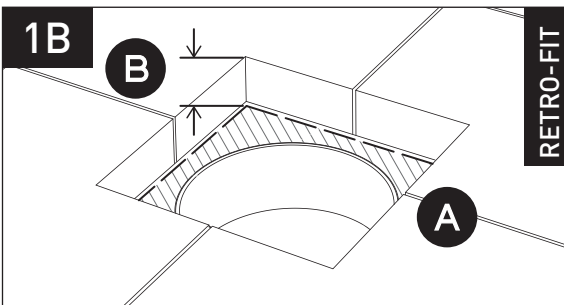

To create recess for Outer Frame:

- Carefully cut existing stone/pavers to create recess for Outer Frame (A).
- Remove debris to a depth suitable for overall height of V-LOCK Lid to be installed (See Page 12) including allowance for mortar or adhesive (B).

# STONE OR PAVER INSTALLATION

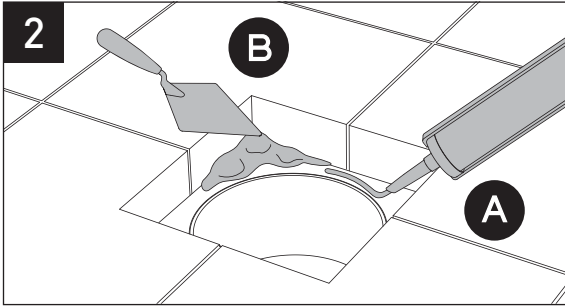

To prepare for Outer Frame install:

- Using an appropriate adhesive, apply a generous, even bead across mounting surface surrounding skimmer opening (A).
- OR**
- Using appropriate mortar mix, insert mortar into recess surrounding skimmer opening (B).

**IMMEDIATELY REMOVE ANY MORTAR OR ADHESIVE THAT FALLS INTO SKIMMER**

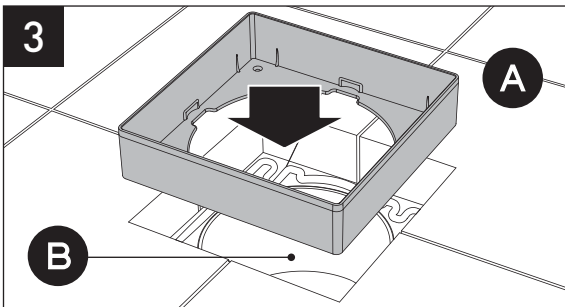

To install Outer Frame:

- Place Outer Frame on mortar or adhesive bed. Outer Frame must be fully supported (A).
- Ensure top rim of Outer Frame is flush with finished stone/paver surface.
- Remove any excess mortar/adhesive and ensure skimmer opening is fully accessible through Outer Frame (B).

**IMMEDIATELY REMOVE ANY MORTAR OR ADHESIVE THAT FALLS INTO SKIMMER**

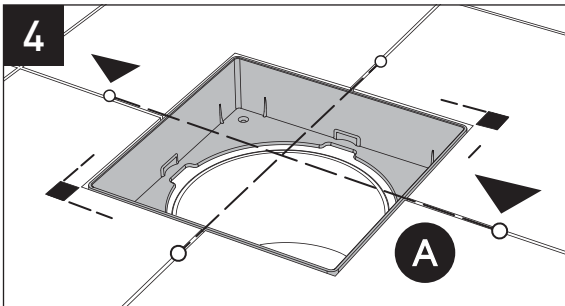

**BEFORE MORTAR OR ADHESIVE IS CURED**

To position Outer Frame:

- Adjust Outer Frame to ensure it is level, square and top rim is flush with finished stone/paver surface (A).

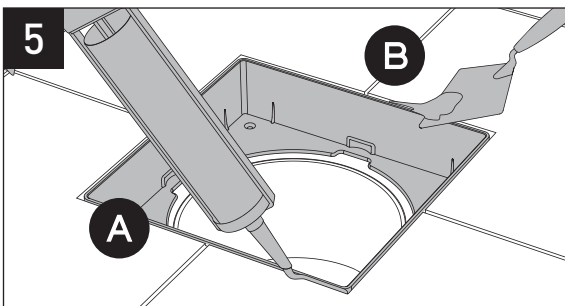

**AFTER MORTAR OR ADHESIVE IS CURED**

To finish Outer Frame:

- **RECOMMENDED** - Fill gap surrounding Outer Frame using a suitable expansion joint gap filler (A).
- **ALTERNATE** - Fill gap surrounding Outer Frame perimeter using preferred mortar/grout compound\* (B).

**IMMEDIATELY REMOVE ANY DEBRIS THAT FALLS INTO SKIMMER. ENSURE OUTER FRAME SIDES REMAIN STRAIGHT DURING GROUTING.**

\* Using rigid grout or mortar may result in gaps/cracking appearing over time due to natural expansion & contraction.

# STONE OR PAVER INSTALLATION

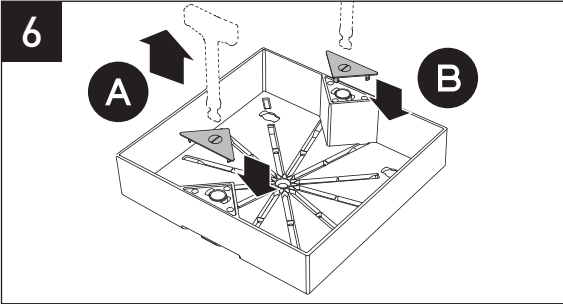

To prepare Lid for paver/stone installation:

- Remove Keys from Lid (A).
- Insert red Construction Caps to protect key openings (B)

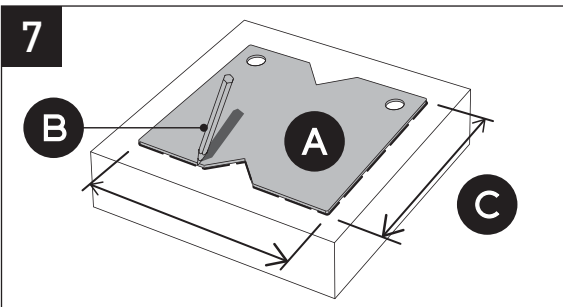

To mark paver/stone:

- Place inlay material with preferred surface facing upwards.
- Position Spacer Template on inlay material in desired position (A).
- Carefully mark perimeter cut-out profile including V-notches (B).
- Confirm dimensions shown match overall "F" & "G" dimensions on Page 12 (C).

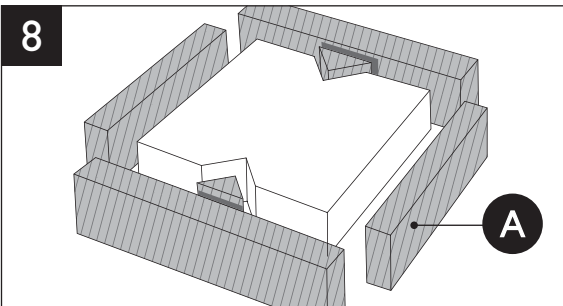

To cut inlay material to size:

- Carefully cut inlay as per marked perimeter including V-notches (A).

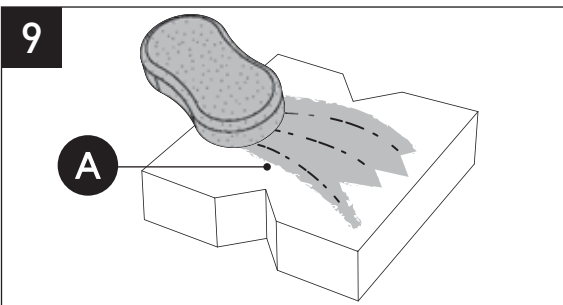

Prepare paver/stone for installation:

- Thoroughly clean and dry inlay on all sides (A).

**ENSURE INLAY IS COMPLETELY DRY AND FREE FROM DUST, OIL, AND DEBRIS BEFORE CONTINUING.**

# STONE OR PAVER INSTALLATION

10A

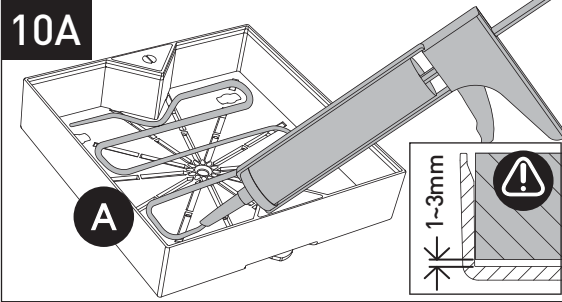

**FOR INLAYS 1-3mm THINNER THAN INTERNAL LID DEPTH**

To apply adhesive:

- Insert appropriate adhesive into caulkung gun & cut nozzle to provide a minimum 6mm wide bead.
- Apply a generous, even bead across entire internal surface of Lid (A).

10B

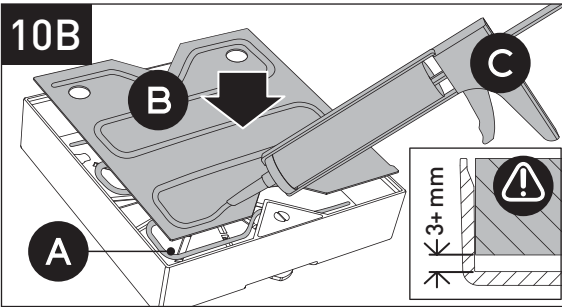

**FOR INLAYS MORE THAN 3mm THINNER THAN INTERNAL LID DEPTH**

To apply adhesive:

- Insert appropriate adhesive into caulkung gun & cut nozzle to provide a minimum 6mm wide bead.
- Apply a generous, even bead across entire internal surface of Lid (A).
- Insert Spacer Template into Lid (B).
- Apply generous, even bead across entire top surface of Spacer Template (C).

11

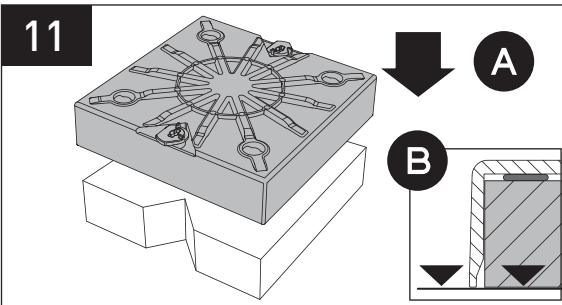

To install paver/stone into Lid:

- Place inlay material face-down on a flat work surface.
- Invert Lid and lower onto inlay material ensuring consistent adhesion across surface of inlay (A) until outer rim of Lid is touching work surface (B).

**\*DO NOT LOWER PAVER INTO LID\*  
LEAVE AND ALLOW ADHESIVE TO PARTIALLY CURE**

12

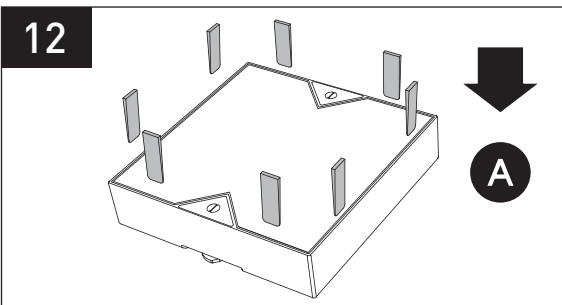

To position paver/stone:

- Carefully flip Lid over and check inlay is centred for consistent grout line thickness.
- If required insert tiling wedges or similar to adjust inlay to correct position (A).

**ALLOW ADHESIVE TO FULLY CURE**

# STONE OR PAVER INSTALLATION

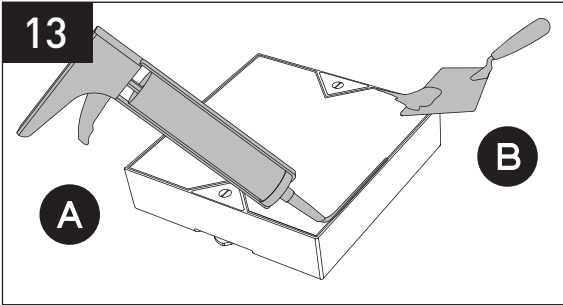

To finish Lid:

- **RECOMMENDED** - Fill gap surrounding inlay using an appropriate expansion joint gap filler (A).
- **ALTERNATE** - Apply preferred mortar or grouting compound (B)\*.

**DO NOT CLEAN LID WITH HARSH CHEMICALS, ACID WASHES OR ABRASIVE MATERIALS**

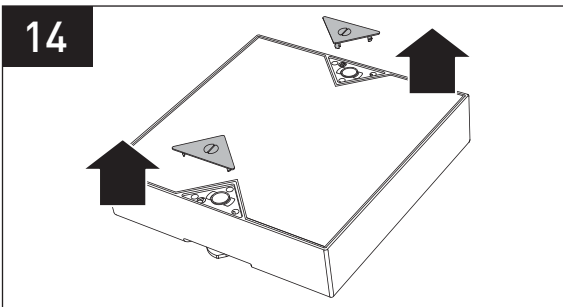

To prepare Lid for Trim Plates:

- Remove red Construction Caps.

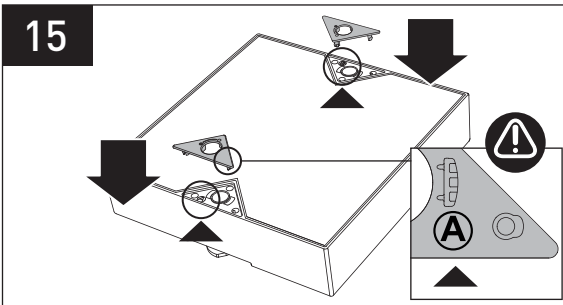

**ENSURE "A" & "B" TRIM PLATES ARE INSERTED INTO CORRECT RECESSES**

To assemble Trim Plates:

- Ensure key openings and surrounding recesses are clean & free from debris.
- Carefully clip Trim Plates into correct recess "A" or "B" as marked.

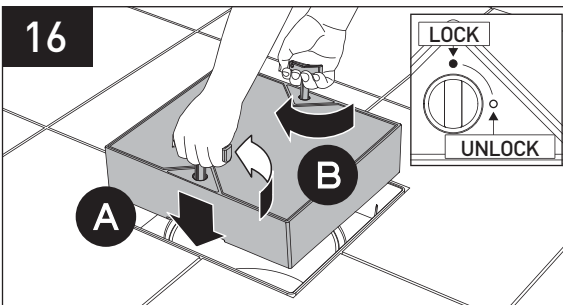

To finish installation:

- Insert Keys into Lid and rotate into the "Unlocked" position.
- Carefully lower Lid into Outer Frame (A).
- Rotate keys into "Locked" position (B) and remove both Keys from Lid.

**STORE KEYS IN SAFE PLACE.  
KEEP KEYS OUT OF REACH OF CHILDREN.**

\* Using rigid grout or mortar may result in gaps/cracking appearing over time due to natural expansion & contraction.

# POURED CONCRETE INSTALLATION



## BEFORE COMMENCING INSTALLATION

1. Remove lid supplied with skimmer box
2. **RECOMMENDED** - Using appropriate tape or equivalent, temporarily cover top opening of skimmer box to prevent concrete or debris falling into skimmer during installation. Remove once installation is complete.
3. Installation instructions assume a solid mounting substrate suitable for securely attaching components with adhesive. (e.g. concrete)
4. Check all kit components in "PARTS LIST" are present (See Page 2)
5. Remove Lid from Outer Frame using Keys (See GENERAL USAGE)

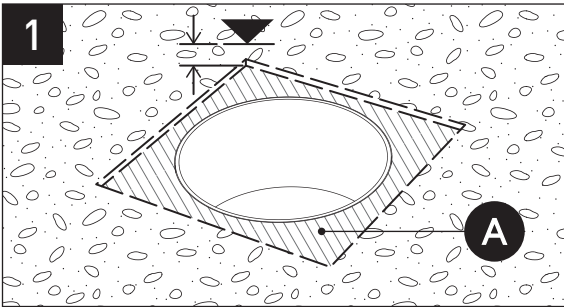

To correctly position Outer Frame:

- Determine finished height of concrete including allowance for loss due to grinding or polishing processes.
- Confirm overall height of V-LOCK Lid (See Page 12).
- Prepare a level surface slightly larger than Outer Frame to suit finished concrete height including allowance for mortar or adhesive under Outer Frame (A).

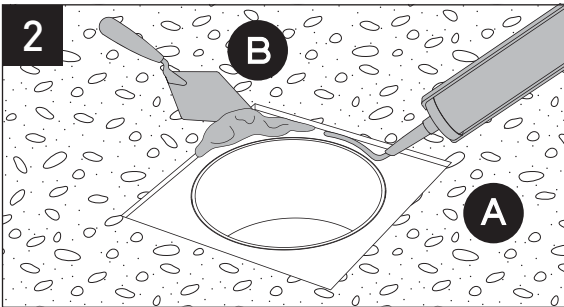

To prepare for Outer Frame install:

- Using an appropriate adhesive, apply a generous, even bead across mounting surface surrounding skimmer opening (A).
- OR**
- Using appropriate mortar mix, apply mortar bed on surface surrounding skimmer opening (B).

**IMMEDIATELY REMOVE ANY MORTAR OR ADHESIVE THAT FALLS INTO SKIMMER**

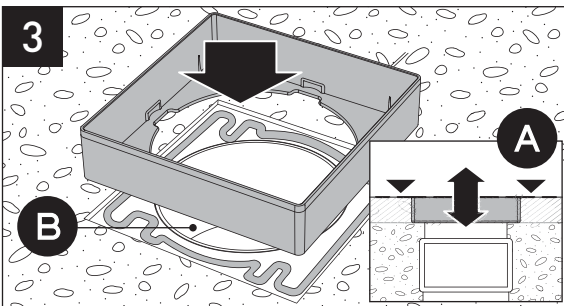

To install Outer Frame:

- Place Outer Frame on mortar or adhesive bed. Outer Frame must be fully supported.
- Ensure top rim of Outer Frame is flush with finished concrete surface (A).
- Remove any excess mortar/adhesive and ensure skimmer opening is fully accessible through Outer Frame (B).

**IMMEDIATELY REMOVE ANY MORTAR OR ADHESIVE THAT FALLS INTO SKIMMER**

# POURED CONCRETE INSTALLATION

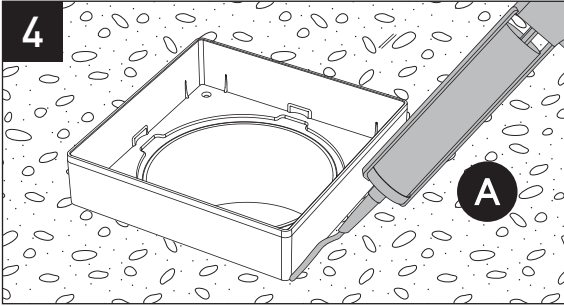

To seal Outer Frame:

- Apply a continuous bead around lower edge of Outer Frame using an appropriate flexible joint sealant (A). Ensure join is fully sealed to prevent concrete leaking under Outer Frame during pouring process.

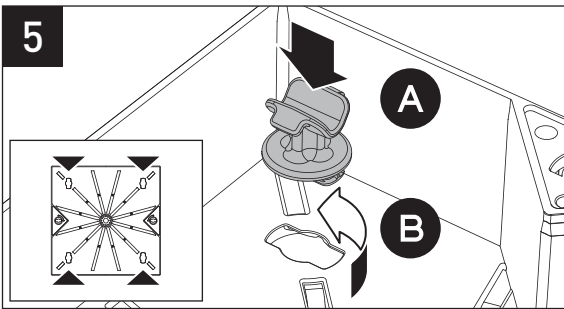

To prepare Lid for concrete:

- Insert Concrete Anchors into Lid floor (4 places) (A).
- Rotate each Concrete Anchor 90 degrees to lock in place (B).

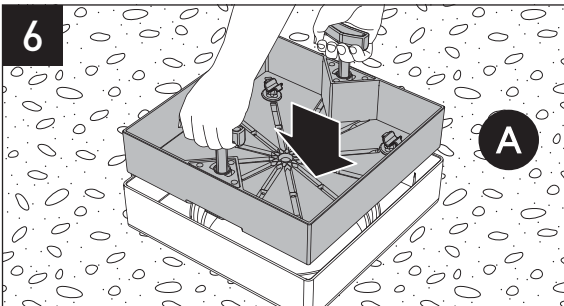

To insert Lid:

- Using Keys insert Lid into Outer Frame and lock in place ensuring latches engage correctly in Outer Frame (A).

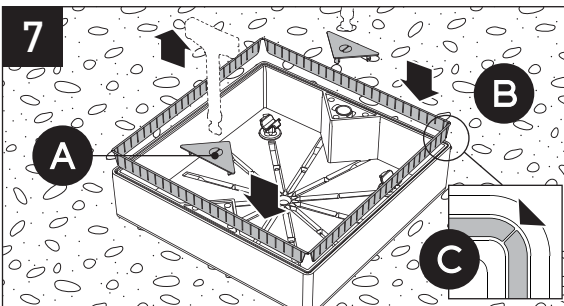

To prepare for concreting:

- Remove Keys.
- Insert red Construction Caps to protect Key openings (A).
- Carefully insert red Construction Spacers into slots between Lid & Outer frame (4 places) (B).
- Ensure Construction Spacers are fully inserted and corners are correctly aligned (C).

# POURED CONCRETE INSTALLATION

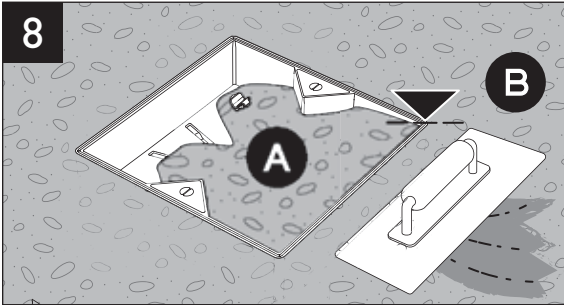

To complete concreting:

- Pour concrete around Outer Frame and into Lid and remove all voids (A).
- Check Outer Frame has remained at correct height & position.
- Carefully trowel concrete flush with top rim removing any excess (B). Apply desired finish to concrete.

**REMOVE ANY CONCRETE THAT FALLS INTO SKIMMER IMMEDIATELY. ENSURE RED CONSTRUCTION CAPS & SPACERS ARE FULLY VISIBLE BEFORE CONCRETE SETS.**

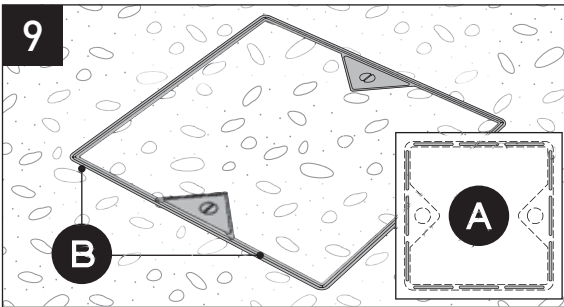

## IF GRINDING OR POLISHING CONCRETE

To apply finish to concrete:

- Carefully grind over lid ensuring surface remains flat and level. Depth indicators will become visible on Construction Spacers when within 1mm of top rim of Lid (A).
- Carefully finish grind or polish until Construction Spacers and rim of Lid & Outer Frame are fully visible (B).

**AVOID CUTTING INTO TOP RIM OF LID & OUTER FRAME DURING GRINDING**

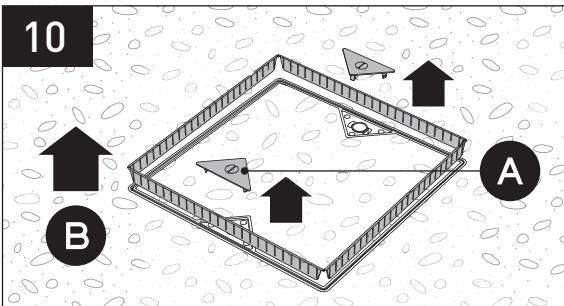

## AFTER FINISHING IS COMPLETE

To prepare Lid for Trim Plates:

- Remove Construction Caps (A).
- Carefully remove Construction Spacers (B).

### HELPFUL TIP

It may be easier to release Construction Spacers by carefully lifting Lid out of Outer Frame using Keys.

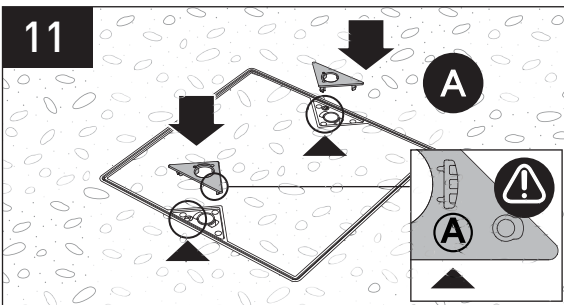

## ENSURE "A" & "B" TRIM PLATES ARE INSERTED INTO CORRECT RECESSES

To assemble Trim Plates:

- Ensure key openings and surrounding recesses are clean & free from debris.
- Carefully clip Trim Plates into correct recess "A" or "B" as marked.

## GENERAL USAGE

### OPENING LID

To unlock Lid:

- Insert Keys into Lid openings (A).
- Rotate Keys 90 degrees to unlock position (B).
- Keys are now captive in Lid.

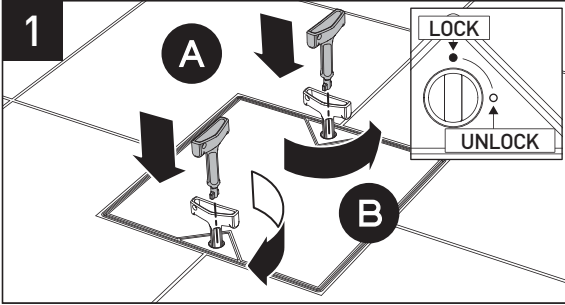

To remove Lid:

- Using Keys as handles lift Lid upwards (A) and remove from Outer Frame.
- Carefully place Lid down next to skimmer box opening.



**LID MAY BE HEAVY. PLEASE TAKE CARE WHEN LIFTING OR SEEK ASSISTANCE.**

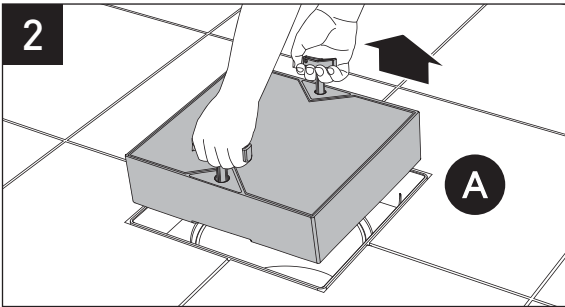

### CLOSING LID

To replace Lid:

- Using Keys as handles, carefully lower Lid into Outer Frame (A).



**LID MAY BE HEAVY. PLEASE TAKE CARE WHEN LIFTING OR SEEK ASSISTANCE.**

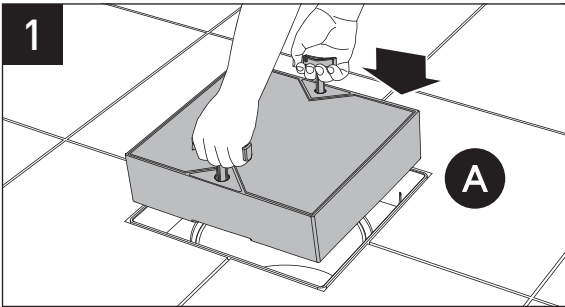

To lock Lid:

- Rotate keys 90 degrees into "Locked" position (A) ensuring latches engage correctly in Outer Frame.
- Remove both Keys from Lid (B).

**STORE KEYS IN SAFE PLACE.  
KEEP KEYS OUT OF REACH OF CHILDREN.**

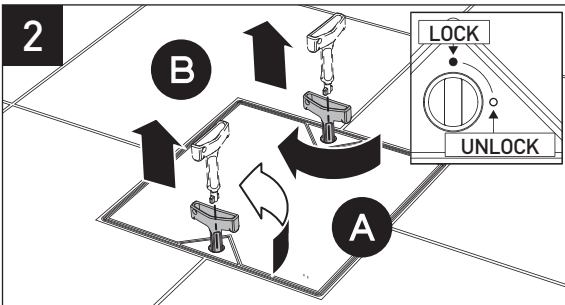

# V40 - DIMENSIONS\*

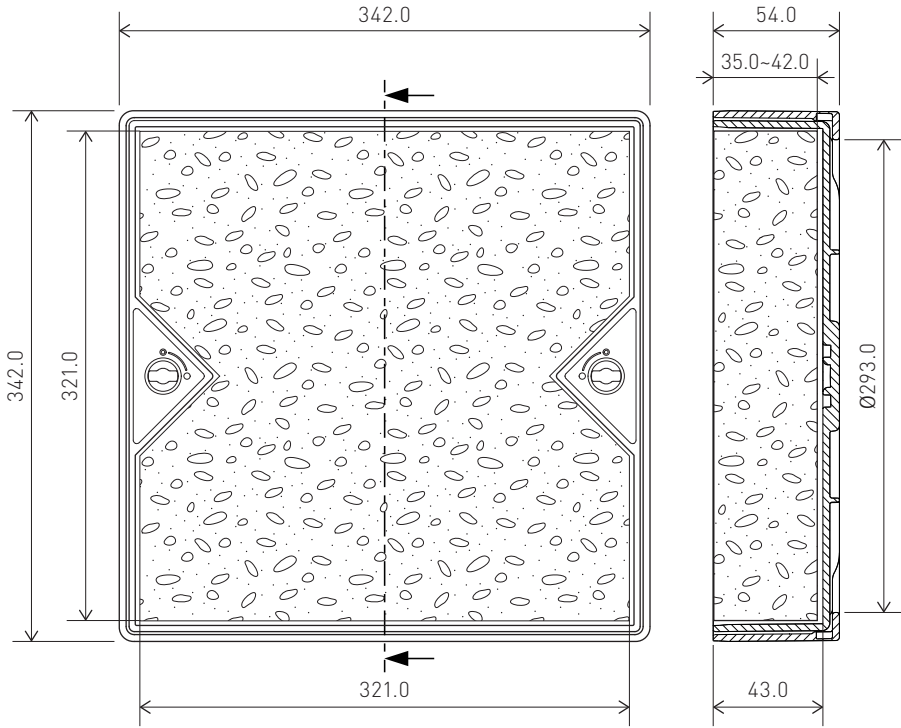

\* TOLERANCE: +/- 1.0mm

# WARRANTY POLICY

[AU Policy Revision 04]

AQUEA (AQUEA Pty. Ltd.) warrants that, subject to the exclusions and limitations below, its products will be free from defects in materials and workmanship for a minimum period of 12 MONTHS from the date of purchase. All warranty periods commence on the date of purchase by the customer and are only valid in original country of purchase. The provisions of this warranty are not transferable.

If a defect appears in any Product supplied by AQUEA before the end of the Warranty Period due solely to defective materials or workmanship, AQUEA will in its sole discretion, and subject to these terms and conditions, either:

- a) repair the Product or the defective part of the Product free of charge; or
- b) have the Product or the defective part of the Product repaired by a qualified repairer free of charge; or
- c) replace the Product.

AQUEA at its sole discretion may replace defective parts of the Products with parts and components of similar quality, grade and composition where an identical part or component is not available. Refurbished parts may be used to repair the Products.

All repairs are to be carried out by AQUEA or its authorised repairer only. This warranty does not cover any costs related to travel, removal or re-installation associated with repair or replacement of the Product.

## TO MAKE A WARRANTY CLAIM

To claim under this warranty the customer should immediately cease use of the Product once alleged defect is identified, and contact AQUEA within 30 days.

To make a claim the customer must:

1. Provide the following information:

- (a) proof of purchase disclosing date and place of purchase;
- (b) full details of the alleged defect; and
- (c) any other appropriate documentation.

2. The customer must make the Product or site available to AQUEA or its authorised repair agent for inspection and testing. If such inspection and testing finds no defect in the Product, the customer must pay AQUEA's usual costs of service work and testing.

3. The customer agrees to pay AQUEA's usual charges (including any service fee) for any goods or services provided by AQUEA not covered by this product warranty.

4. The customer is responsible for the cost of transport and all insurance of the Product to and from AQUEA or its authorised repair agent.

## WARRANTY CONDITIONS

This warranty only applies where the following conditions are met:

1. The customer complies with the following general maintenance requirements:

- (a) The Product is maintained free from general debris or foreign matter.
- (b) The Product is maintained and serviced regularly (at least every 12 months) by a suitably qualified professional.
- (c) Where applicable, the Product is replaced at specified intervals as outlined in product literature by AQUEA.

2. Where applicable, Product has been used in pool or spa water which:

- (a) is maintained within a pH range of 7.2-7.6, and chemically balanced as per accepted industry standards.
- (b) is regularly (at least once a month) treated with a sanitising system in compliance with applicable regulatory recommendations or regulations.
- (c) has not exceeded 40 degrees Celsius in temperature.
- (d) has not been exposed to freezing conditions.

## WARRANTY EXCLUSIONS

This warranty will not apply where:

- (a) the Product has not been installed in accordance with the installation instructions provided with the Product, any statutory requirements and these terms and conditions;
- (b) the Product has not been installed by a suitably qualified professional trained in the installation and operation of such products with more than 12 months industry experience;
- (c) a failure to observe and comply with the instructions supplied with product for the proper use, service or maintenance of the Product has occurred;
- (d) the Product has been used for a purpose other than that for which it was designed and manufactured;
- (e) removal or installation of the Product has contributed to, or resulted in, the defect or damage;
- (f) the Product has been repaired, altered or modified by someone other than AQUEA or its authorised agent;
- (g) substitute or replacement parts not provided by AQUEA have been used;
- (h) the defect has arisen due to abuse, misuse, neglect, or accident;
- (i) the Product has been subject to abnormal conditions, including environment, temperature, water, fire or other acts of nature;
- (j) the Product has been subject to abnormal corrosive conditions or abrasive chemicals;
- (k) the defect is the result of corrosion or normal wear and tear;
- (l) the defect is the result of insect and/or vermin infestation;
- (m) concrete, cement, render, pebbles or other pool surface finishes contribute to the defect, or inhibit proper function of the Product;
- (n) the damage occurred in transit;
- (o) after testing and inspection AQUEA cannot establish any fault in the Product;
- (p) the Product has been used in a commercial application;
- (q) the Product has not been supplied by AQUEA;
- (r) the defect is related to any cause other than a defect in the materials or workmanship of the Product.

## LIMITATIONS

AQUEA makes no express warranties or representations other than set out in this warranty.

Except to the extent required by the Australian Consumer Law, the repair or replacement of the Product or part of the Product is the absolute limit of AQUEA's liability under this express warranty.

To the extent permitted by law, AQUEA will not be liable for:

- (a) Damage to any other property caused by defect in the Product.
- (b) Any indirect, special or consequential loss arising from or related to defects in the Product, including, but not limited to, loss of time, loss of use of the product, loss of business opportunity, loss of profits, loss of revenue, loss of goodwill, or inconvenience.
- (c) Any other damage as a result of weather or natural disaster.
- (d) Any claim against the customer by other parties.

Our goods come with guarantees that cannot be excluded under the Australian Consumer Law. You are entitled to a replacement or refund for a major failure and for compensation for any other reasonably foreseeable loss or damage. You are also entitled to have the goods repaired or replaced if the goods fail to be of acceptable quality and the failure does not amount to a major failure.

The benefits of this warranty are in addition to any rights and remedies imposed by Australian State and Federal legislation that cannot be excluded. Nothing in this warranty is to be interpreted as excluding, restricting or modifying any State or Federal legislation applicable to the supply of goods and services which cannot be excluded, restricted or modified.

## CONTACT

For warranty claims visit [www.aquea.com.au](http://www.aquea.com.au) or contact AQUEA using details overleaf.

---

BUILD A  
BETTER  
POOL

---

**AQUEA**

---

[WWW.AQUEA.COM.AU](http://WWW.AQUEA.COM.AU)

U12/22-24 REDLAND DRIVE, MITCHAM, VICTORIA 3132.  
**SALES & SUPPORT ENQUIRIES - [HELLO@AQUEA.COM.AU](mailto:HELLO@AQUEA.COM.AU)**  
**PHONE - 0481 875 870**

# AQUEA

---

## V-LOCK LID

---

INSTALLATION & CARE GUIDE  
GUIDE D'INSTALLATION ET D'ENTRETIEN  
GUÍA DE INSTALACIÓN Y CUIDADO

---

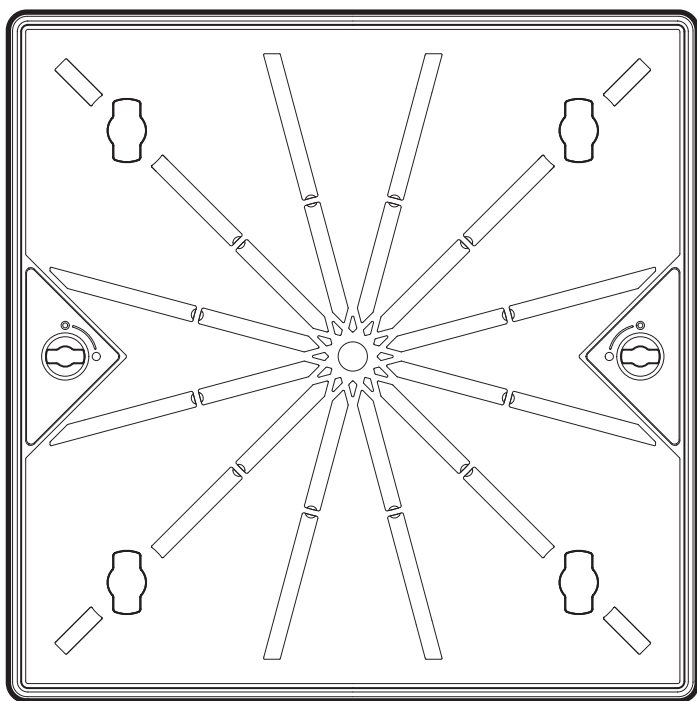

**M60**

---

MODEL-MODÈLE-MODELO M60 | PART-PIÈCE-PARTE 475-223

---



# INSTALLER | INSTALLATEUR | INSTALADOR



EN

1. Read this document prior to installation. Improper installation will void warranty.
2. Product only to be installed & serviced by a suitably qualified professional.
3. Do not use acid/chemical washes. Discoloration may occur and will void warranty.
4. Installer to ensure installation meets all applicable engineering & regulatory requirements.
5. This manual contains important information. Once installation is complete installer must provide this manual to owner/operator to store in a safe place.

FR

1. Lisez ce document avant l'installation. Une installation incorrecte annulera la garantie.
2. Le produit ne doit être installé et réparé que par un professionnel dûment qualifié.
3. N'utilisez pas de produits de lavage acides/chimiques. Une décoloration peut se produire et annulera la garantie.
4. L'installateur doit s'assurer que l'installation répond à toutes les exigences techniques et réglementaires applicables.
5. Ce manuel contient des informations importantes. Une fois l'installation terminée, l'installateur doit fournir ce manuel au propriétaire/opérateur pour qu'il le conserve dans un endroit sûr.

ESP

1. Lea este documento antes de la instalación. Una instalación incorrecta anulará la garantía.
2. El producto solo debe ser instalado y reparado por un profesional debidamente calificado.
3. No utilice lavados ácidos/químicos. Puede producirse decoloración y anulará la garantía.
4. El instalador debe garantizar que la instalación cumpla con todos los requisitos reglamentarios y de ingeniería aplicables.
5. Este manual contiene información importante. Una vez completada la instalación, el instalador debe proporcionar este manual al propietario/oprador para que lo guarde en un lugar seguro.



EN

PLEASE ENSURE SUITABLE PERSONAL PROTECTION EQUIPMENT AND SAFE WORK PRACTICES ARE USED.

FR

VEUILLEZ VOUS ASSURER QUE DES ÉQUIPEMENTS DE PROTECTION INDIVIDUELLE APPROPRIÉS ET DES PRATIQUES DE TRAVAIL SÉCURISÉES SONT UTILISÉS.

ESP

ASEGÚRESE DE UTILIZAR EQUIPOS DE PROTECCIÓN PERSONAL ADECUADOS Y PRÁCTICAS DE TRABAJO SEGURAS.





# OPERATOR | OPÉRATEUR | OPERADOR



EN

1. See "General Usage" section for correct operation of lid.
2. Do not carry lid with keys as this may cause injury or damage.
3. Lid may be heavy **27 ~ 31 lbs (12 - 14 kgs)** and should only be operated by a capable adult.
4. Ensure fingers & toes are clear of lid when lowering to avoid injury.
5. Always remove keys from lid once locked. Store keys in safe place out of reach of children.
6. Do not use harsh chemicals, acids or abrasive materials to clean lid, outer frame or keys.
7. For reliable operation, keep lid free of dirt, sand and debris.
8. Do not open skimmer while pump is operating.

FR

1. Voir la section "Utilisation générale" pour un fonctionnement correct du couvercle.
2. Ne transportez pas le couvercle avec les clés, car cela pourrait causer des blessures ou des dommages.
3. Le couvercle peut être lourd de **27 à 31 lb (12 à 14 kg)** et ne doit être utilisé que par un adulte capable.
4. Assurez-vous que les doigts et les orteils sont dégagés du couvercle lors de l'abaissement pour éviter les blessures.
5. Retirez toujours les clés du couvercle une fois verrouillées. Rangez les clés dans un endroit sûr, hors de la portée des enfants.
6. N'utilisez pas de produits chimiques agressifs, d'acides ou de matériaux abrasifs pour nettoyer le couvercle, le cadre extérieur ou les clés.
7. Pour un fonctionnement fiable, gardez le couvercle exempt de saleté, de sable et de débris.
8. N'ouvrez pas l'écumoire pendant que la pompe fonctionne.

ESP

1. Consulte la sección "Uso general" para conocer el funcionamiento correcto de la tapa.
2. No cargue la tapa con las llaves, ya que esto puede causar lesiones o daños.
3. La tapa puede ser pesada de **27 ~ 31 libras (12 a 14 kg)** y solo debe ser operada por un adulto capaz.
4. Asegúrese de que los dedos de las manos y los pies estén fuera de la tapa al bajarla para evitar lesiones.
5. Retire siempre las llaves de la tapa una vez cerrada. Guarde las llaves en un lugar seguro fuera del alcance de los niños.
6. No utilice productos químicos agresivos, ácidos o materiales abrasivos para limpiar la tapa, el marco exterior o las llaves.
7. Para un funcionamiento confiable, mantenga la tapa libre de suciedad, arena y desechos.
8. No abra el skimmer mientras la bomba esté funcionando.

US DESIGN PATENT APPLICATION NO. - US29/897,809, US29/897,815, US29/897,817

CA DESIGN PATENT APPLICATION NO. - CA222,969, CA222,970, CA222,971

AUSTRALIAN DESIGNS NO. - 202310380, 202310379, 202310378

**[EN]** The contents of this manual are the exclusive copyright of AQUEA® and may not be reproduced without written permission. © 2024 Whilst every care was taken in preparation of this document, AQUEA® accepts no responsibility for the accuracy of the information supplied. Specifications subject to change without notice.

**[FR]** Le contenu de ce manuel est la propriété exclusive d'AQUEA® et ne peut être reproduit sans autorisation écrite. © 2024 Bien que tous les soins aient été apportés à la préparation de ce document, AQUEA® n'accepte aucune responsabilité quant à l'exactitude des informations fournies. Les spécifications sont sujettes à changement sans préavis.

**[ESP]** El contenido de este manual es propiedad exclusiva de AQUEA® y no puede reproducirse sin permiso por escrito. © 2024 Si bien se puso todo el cuidado en la preparación de este documento, AQUEA® no acepta ninguna responsabilidad por la exactitud de la información proporcionada. Las especificaciones están sujetas a cambios sin previo aviso.

# CONTENTS | CONTENU | CONTENIDO

PAGE

EN

PARTS LIST .....	1
<b>INSTALLATION OPTIONS</b>	
RECOMMENDED INSTALLATION ACCESSORIES .....	2
STONE OR PAVER INSTALLATION .....	3
CONCRETE INSTALLATION - WITH LID IN PLACE .....	8
CONCRETE INSTALLATION - WITH LID REMOVED .....	11
GENERAL USAGE .....	15
PRODUCT DIMENSIONS .....	44
WARRANTY POLICY .....	45

FR

LISTE DES PIÈCES .....	1
<b>OPTIONS D'INSTALLATION</b>	
ACCESSOIRES D'INSTALLATION RECOMMANDÉS .....	16
INSTALLATION EN PIERRE OU EN PAVÉ .....	17
INSTALLATION EN BÉTON - AVEC COUVERCLE EN PLACE .....	22
INSTALLATION EN BÉTON - AVEC COUVERCLE RETIRÉ .....	25
USAGE GÉNÉRAL .....	29
DIMENSIONS DU PRODUIT .....	44
POLITIQUE DE GARANTIE .....	46

ESP

LISTA DE PIEZAS .....	1
<b>OPCIONES DE INSTALACIÓN</b>	
ACCESORIOS DE INSTALACIÓN RECOMENDADOS .....	30
INSTALACIÓN DE PIEDRA O ADOQUÍN .....	31
INSTALACIÓN DE HORMIGÓN - CON LA TAPA EN SU LUGAR .....	36
INSTALACIÓN DE HORMIGÓN - SIN LA TAPA .....	39
USO GENERAL .....	43
DIMENSIONES DEL PRODUCTO .....	44
POLÍTICA DE GARANTÍA .....	47

# PARTS LIST - LISTE DES PIÈCES - LISTA DE PIEZAS

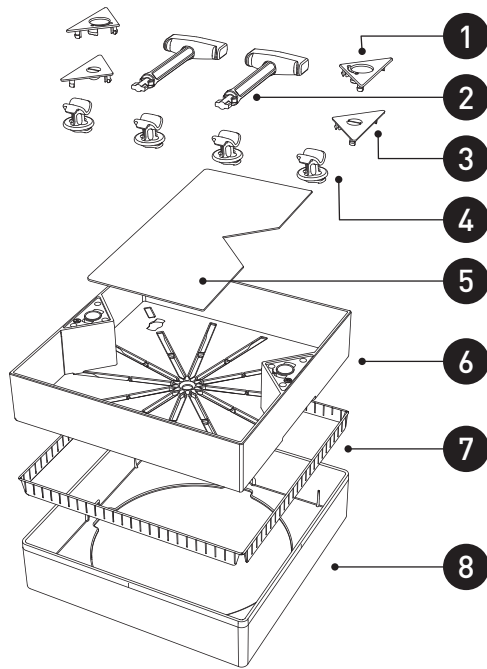

	PART - PIÈCE - PARTE	NAME - NOM - NOMBRE	QTY - QTÉ - CANT
<b>1</b>	475-245	Trim Plate Plaque de garniture Placa de acabado	2
<b>2</b>	475-241	Key Clé Llave	2
<b>3</b>	475-493	Construction Cap Capuchon de construction Tapa de construcción	2
<b>4</b>	475-247	Concrete Anchor Ancrage pour béton Clavija de hormigón	4
<b>5</b>	475-4100	Paver Template Gabarit de pavé Plantilla de adoquín	1
<b>6</b>	475-426	Lid Couvercle Tapa	1
<b>7</b>	475-495	Construction Spacer Entretoise de construction Espaciador de construcción	4
<b>8</b>	475-427	Outer Frame Cadre extérieur Marco exterior	1



## READ BEFORE COMMENCING INSTALLATION

For best results, AQUEA recommends the use of these accessories (sold separately). The installation steps in this guide assume the use of these recommended accessories. Installers who choose not to use these accessories take responsibility for devising alternative methods to ensure correct installation.

P/N. 475-4104

M60 V-GUARD - SAFETY GUARD

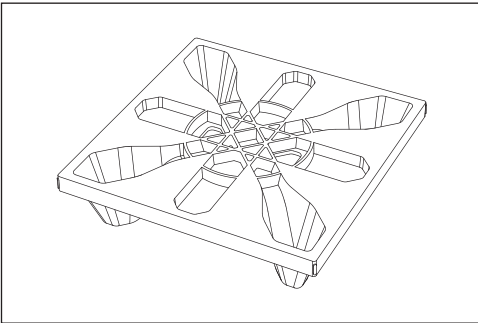

The reusable V-GUARD safety guard reduces trip/fall hazards on the worksite and prevents debris from entering the skimmer.

**It is strongly recommended for poured concrete installations** as additional protection against damage or distortion of the Outer Frame during concreting.

P/N. 475-243

M-SERIES - Poured Deck Skimmer Collar

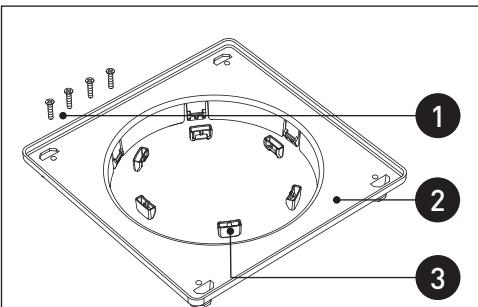

The Poured Deck Skimmer Collar simplifies attachment and set-up of the V-LOCK Lid onto popular skimmers in poured concrete applications.

The Poured Deck Skimmer Collar allows height and angle adjustment to suit the finished deck surface, and ensures a fully integrated look when the skimmer lid is open.

Suits skimmer top opening outer diameter

8-3/4" ~ 9-1/8" IN. | PO | 223.0 ~ 232.0 mm

	P/N	NAME	QTY
1	475-511	Screw	4
2	475-494	Adapter	1
3	475-496	Cap	6



## READ BEFORE COMMENCING INSTALLATION

1. Remove lids supplied with skimmer or sump pipe
2. **RECOMMENDED** - Using appropriate tape or equivalent, temporarily cover top opening of skimmer to prevent concrete or debris falling into skimmer during installation. Remove once installation is complete.
3. Check all kit components in "PARTS LIST" are present (See Page 1)
4. Remove Lid from Outer Frame using Keys (See GENERAL USAGE)

## NEW BUILD

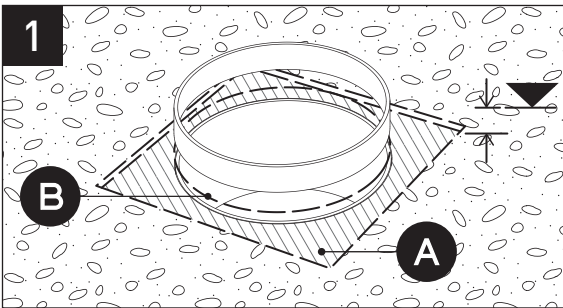

To correctly position Outer Frame:

- Determine finished height of installed stone/pavers.
- Confirm overall height of V-LOCK Lid (See Page 44).
- Prepare a level surface slightly larger than Outer Frame to suit finished paver height including allowance for mortar or adhesive (A).
- If required, trim skimmer extension collar to be flush with bottom surface of Outer Frame. (B)

## RETRO-FIT

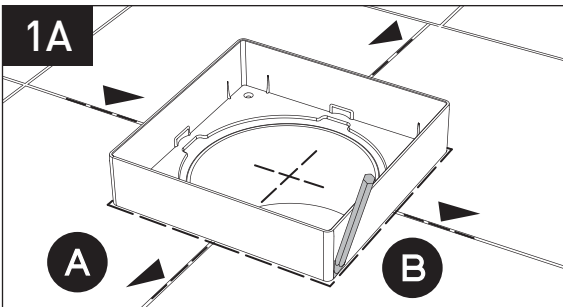

To correctly position Outer Frame:

- Align Outer Frame to existing skimmer opening (A).
- Mark perimeter of Outer Frame on surrounding stone/pavers (B).

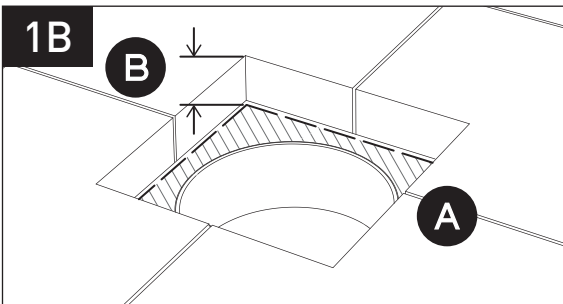

To create recess for Outer Frame:

- Carefully cut existing stone/pavers to create recess for Outer Frame (A).
- Remove debris to a depth suitable for overall height of V-LOCK Lid (See Page 44) including allowance for mortar or adhesive (B).

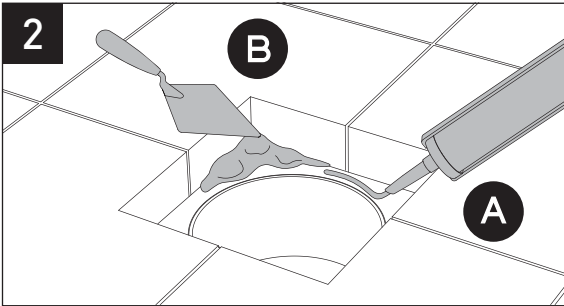

To prepare for Outer Frame install:

- Using an appropriate adhesive, apply a generous, even bead across mounting surface surrounding skimmer opening (A).
- OR
- Using appropriate mortar mix, insert mortar into recess surrounding skimmer opening (B).

**IMMEDIATELY REMOVE ANY MORTAR OR ADHESIVE THAT FALLS INTO SKIMMER**

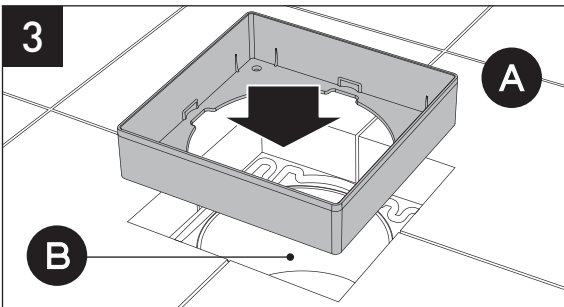

To install Outer Frame:

- Place Outer Frame on mortar or adhesive bed (A). Outer Frame must be fully supported.
- Ensure top rim of Outer Frame is flush with finished stone/paver surface
- Remove any excess mortar/adhesive and ensure skimmer opening is fully accessible through Outer Frame (B).

**IMMEDIATELY REMOVE ANY MORTAR OR ADHESIVE THAT FALLS INTO SKIMMER**

## BEFORE MORTAR OR ADHESIVE IS CURED

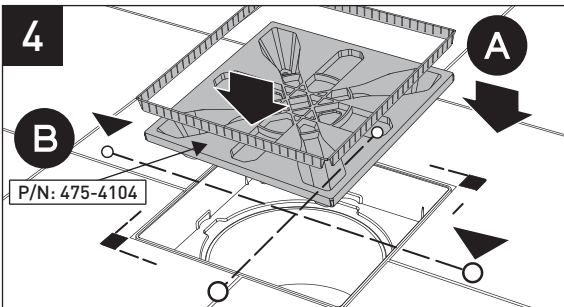

To position Outer Frame:

- **RECOMMENDED** - Insert M60 V-GUARD\*\* and Construction Spacers into Outer Frame (A).
- Adjust Outer Frame to ensure it is level, square and top rim is flush with finished stone/paver surface (B).

\*\* M60 V-GUARD sold separately.  
(P/N: 475-4104)

## AFTER MORTAR OR ADHESIVE IS CURED

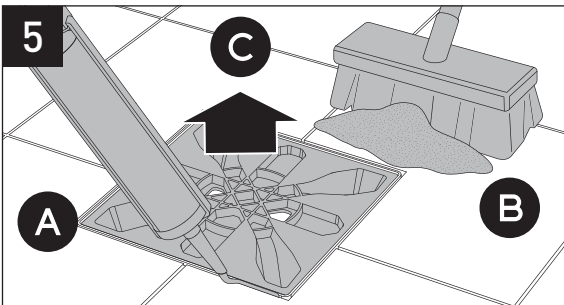

To finish Outer Frame:

- **RECOMMENDED** - Fill gap surrounding Outer Frame using a suitable expansion joint gap filler (A).
- **ALTERNATE** - Fill gap surrounding Outer Frame using preferred grout or sand\* (B).
- Remove M60 V-GUARD & Spacers after grout has cured/set (C).

**IMMEDIATELY REMOVE ANY SAND THAT FALLS INTO SKIMMER. ENSURE OUTER FRAME SIDES REMAIN STRAIGHT DURING GROUTING.**

\* Using rigid grout or mortar may result in gaps/cracking appearing over time due to natural expansion & contraction.

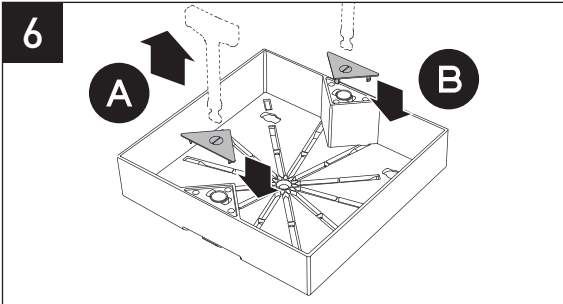

To prepare Lid for paver/stone installation:

- Remove Keys from Lid (A).
- Insert red Construction Caps to protect key openings (B)

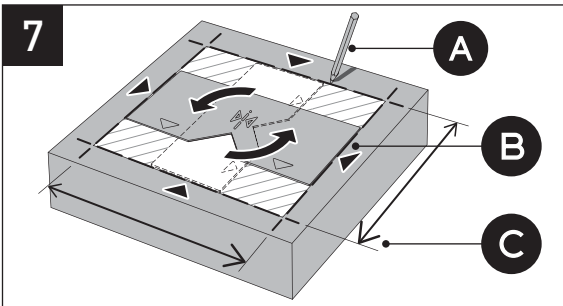

To cut paver/stone to size:

- Place inlay material with preferred surface facing upwards.
- Position Paver Template on inlay material & carefully mark overall size as shown (A).
- Rotate Paver Template 90 degrees and mark overall size in other direction (B).
- Confirm markings are square & sizing matches **dimension C on Page 44** before carefully cutting inlay to size (C).

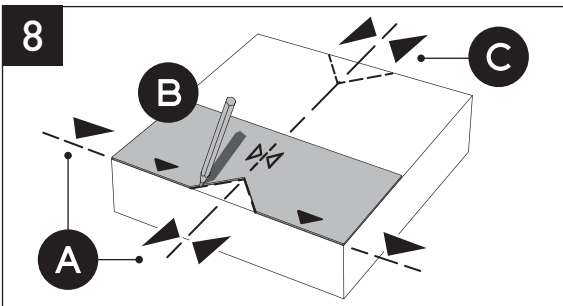

To mark cut-outs:

- Place inlay material with preferred surface facing upwards.
- Position Paver Template on inlay material.
- Align & centre V-notch edge of Paver Template with selected edge of inlay (A).
- Carefully mark V-notch cut-out profile (B).
- Repeat process on opposite side of inlay (C).

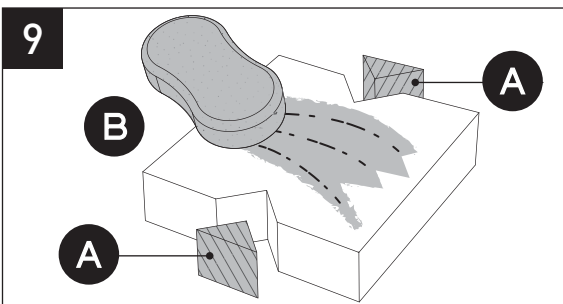

Prepare paver/stone for installation:

- Carefully cut and remove V-notch material from both sides of inlay (A).
- Thoroughly clean and dry inlay on all sides (B).

**ENSURE INLAY IS COMPLETELY DRY AND FREE FROM DUST, OIL, AND DEBRIS BEFORE CONTINUING.**

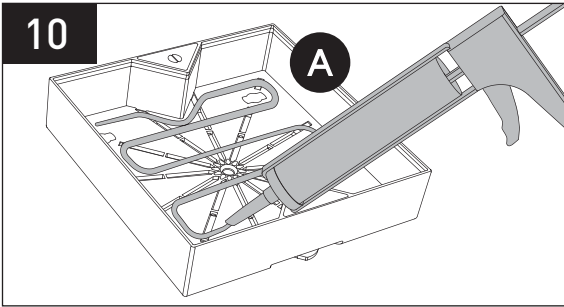

To apply adhesive :

- Insert appropriate adhesive into caulking gun & cut nozzle to provide a minimum 1/4" [6mm] wide bead.
- Apply a generous, even bead across entire internal surface of Lid (A).

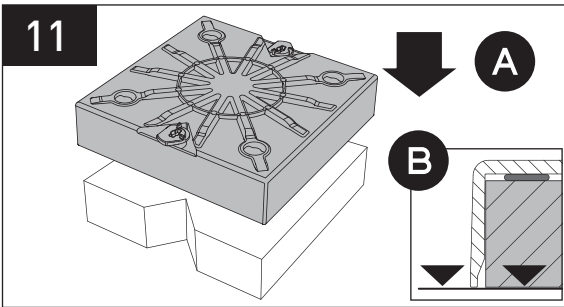

To install paver/stone into Lid:

- Place inlay material face-down on a flat work surface.
- Invert Lid and lower onto inlay material ensuring consistent adhesion across surface of inlay (A) until outer rim of Lid is touching work surface (B).
- **Do not lower paver into lid.**

**LEAVE AND ALLOW ADHESIVE TO PARTIALLY CURE**

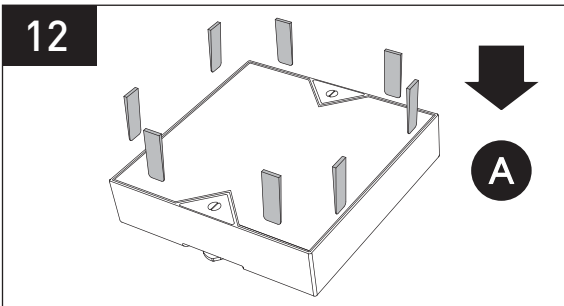

To position paver/stone:

- Carefully flip Lid over and check inlay is centred for consistent grout line thickness.
- If required, insert tiling wedges or similar to adjust inlay to correct position (A).

**ALLOW ADHESIVE TO FULLY CURE**

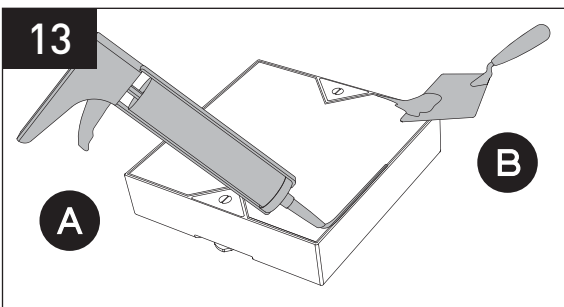

To finish Lid:

- **RECOMMENDED** - Fill gap surrounding inlay using an appropriate expansion joint grout filler (A).
- **ALTERNATE** - Apply preferred mortar or grouting compound (B)\*.

**DO NOT CLEAN LID WITH HARSH CHEMICALS, ACID WASHES OR ABRASIVE MATERIALS**

\* Using rigid grout or mortar may result in gaps/cracking appearing over time due to natural expansion & contraction.

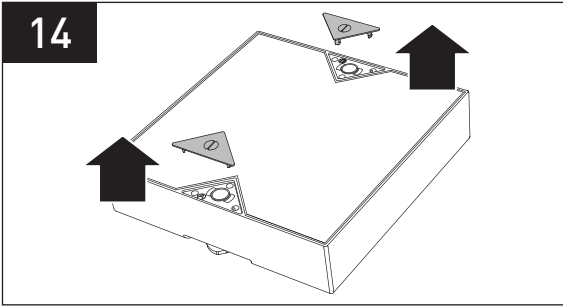

- To prepare Lid for Trim Plates:
- Remove red Construction Caps.

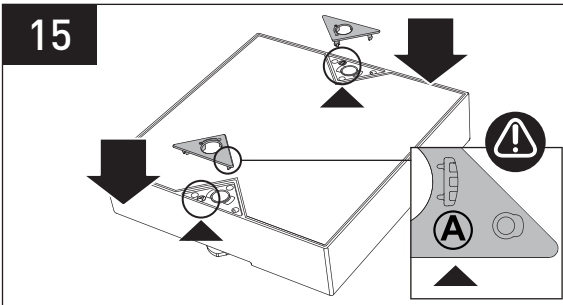

### ENSURE "A" & "B" TRIM PLATES ARE INSERTED INTO CORRECT RECESSES

To assemble Trim Plates:

- Ensure key openings and surrounding recesses are clean & free from debris.
- Carefully clip Trim Plates into correct recess "A" or "B" as marked.

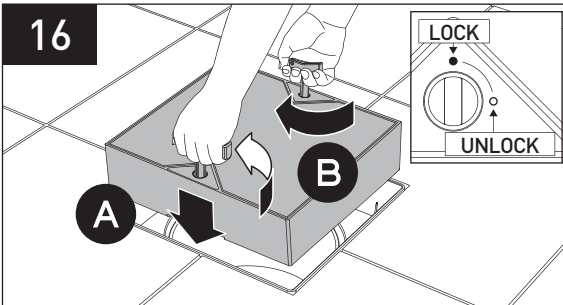

To finish installation:

- Insert Keys into Lid and rotate into the "Unlocked" position.
- Carefully lower Lid into Outer Frame (A).
- Rotate keys into "Locked" position (B) and remove both Keys from Lid.

**STORE KEYS IN SAFE PLACE.  
KEEP KEYS OUT OF REACH OF CHILDREN.**

**SEE "GENERAL USAGE" (PAGE 15)  
FOR CORRECT OPERATION OF LID.**



## READ BEFORE COMMENCING INSTALLATION

1. Remove lids supplied with skimmer or sump pipe
2. **RECOMMENDED** - Using appropriate tape or equivalent, temporarily cover top opening of skimmer to prevent concrete or debris falling into skimmer during installation. Remove once installation is complete.
3. Check all kit components in "PARTS LIST" are present (See Page 1)
4. Remove Lid from Outer Frame using Keys (See GENERAL USAGE)

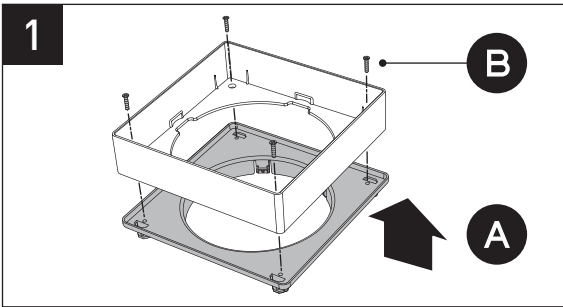

**RECOMMENDED** - Attach Poured Deck Skimmer Collar\*\*

- Assemble Adapter to underside of Outer Frame (A).
- Fasten in place using Screws provided (B).

**HAND TIGHTEN ONLY - DO NOT USE POWER TOOLS.**

**DO NOT OVERTIGHTEN SCREWS AS THIS CAN CAUSE DAMAGE TO PLASTIC PART.**

\*\* Poured Deck Skimmer Collar sold separately. (P/N: 475-243)

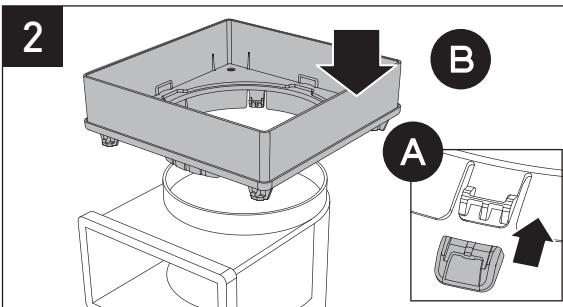

To locate Outer Frame on skimmer:

- Check fit of Poured Deck Skimmer Collar **OVER** skimmer opening or extension collar. The six springs should flex slightly for correct fitment to skimmer. If required, attach Caps to end of springs to remove excess clearance (A).
- Slide Outer Frame with Collar over top skimmer opening as shown (B).

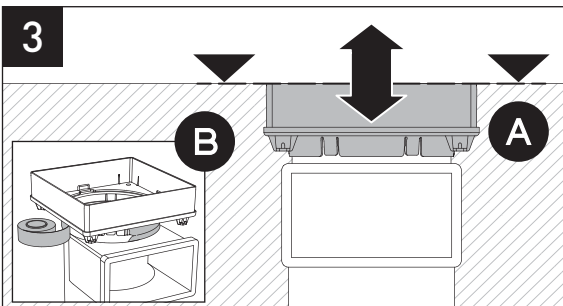

To correctly position Outer Frame:

- Ensure height and position of Outer Frame is level, square and top surface matches finished concrete height (A).
- Secure Outer Frame into position with appropriate tape or equivalent (B).

**ENSURE ATTACHMENT IS SEALED TO PREVENT CONCRETE ENTERING SKIMMER.**

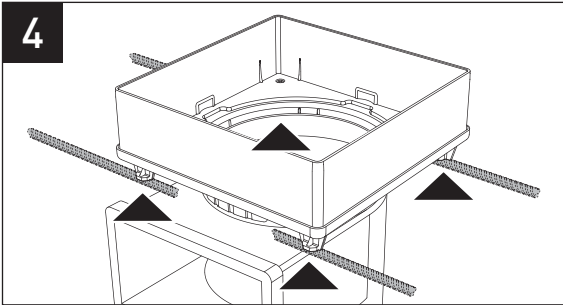

To support Outer Frame:

- Provide additional reinforcing and support as required to prevent Outer Frame moving during concreting process.

**ENSURE SUPPORT DOES NOT COMPROMISE INTEGRITY OF SURROUNDING CONCRETE STRUCTURE**

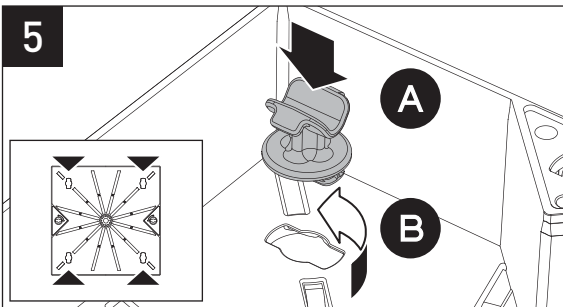

To prepare Lid for concrete:

- Insert Concrete Anchors into Lid floor (4 places) (A).
- Rotate each Concrete Anchor 90 degrees to lock in place (B).

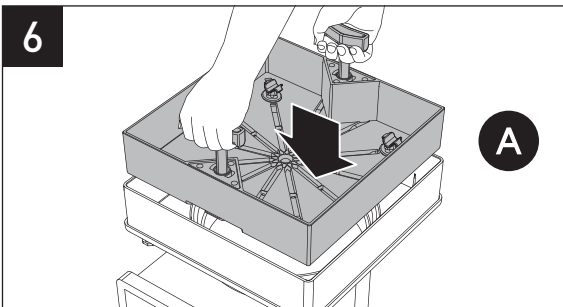

To insert Lid:

- Using Keys insert Lid into Outer Frame and lock in place (A).

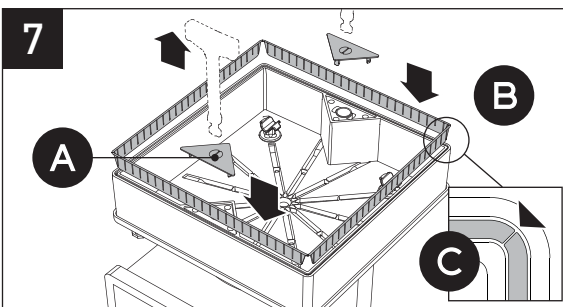

To prepare for concreting:

- Remove Keys.
- Insert red Construction Caps to protect Key openings (A).
- Carefully insert red Construction Spacers into slots between Lid & Outer frame (4 places) (B).
- Ensure top of Construction Spacers are flush with surrounding rim and corners are correctly aligned (C).

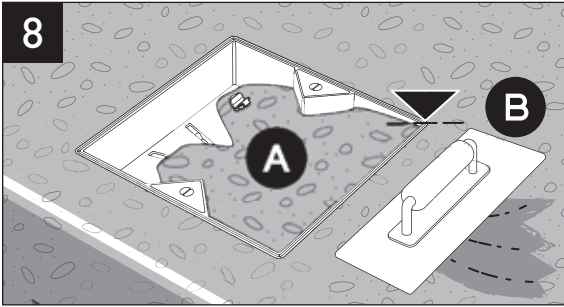

To complete concreting:

- Pour concrete around Outer Frame and into Lid and remove all voids (A).
- Check Outer Frame has remained at correct height & position.
- Carefully trowel concrete flush with top rim removing any excess (B). Apply desired finish to concrete.

**REMOVE ANY CONCRETE THAT FALLS INTO SKIMMER IMMEDIATELY. ENSURE RED CONSTRUCTION CAPS & SPACERS ARE FULLY VISIBLE BEFORE CONCRETE SETS.**

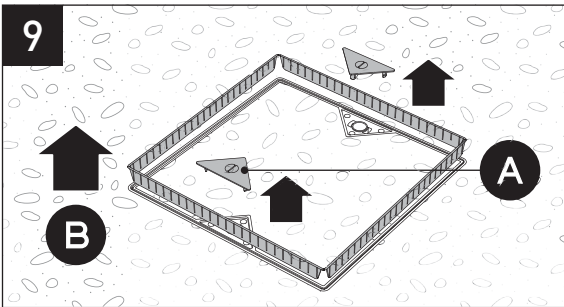

## AFTER CONCRETE HAS SET

To prepare Lid for Trim Plates:

- Remove Construction Caps (A).
- Carefully remove Construction Spacers (B).

### HELPFUL TIP

It may be easier to release Construction Spacers by carefully removing Lid from Outer Frame using Keys.

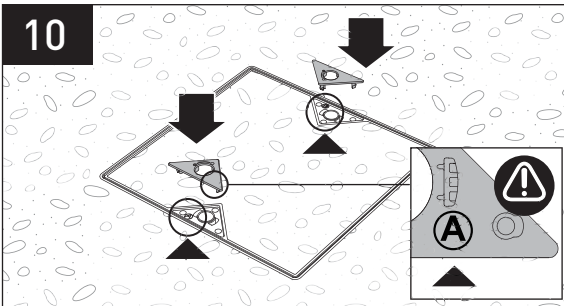

## ENSURE "A" & "B" TRIM PLATES ARE INSERTED INTO CORRECT RECESSES

To assemble Trim Plates:

- Ensure key openings and surrounding recesses are clean & free from debris.
- Carefully clip Trim Plates into correct recess "A" or "B" as marked.

**SEE "GENERAL USAGE" (PAGE 15)  
FOR CORRECT OPERATION OF LID.**



## READ BEFORE COMMENCING INSTALLATION

1. Remove lids supplied with skimmer or sump pipe
2. **RECOMMENDED** - Using appropriate tape or equivalent, temporarily cover top opening of skimmer to prevent concrete or debris falling into skimmer during installation. Remove once installation is complete.
3. Check all kit components in "PARTS LIST" are present (See Page 1)
4. Remove Lid from Outer Frame using Keys (See GENERAL USAGE)

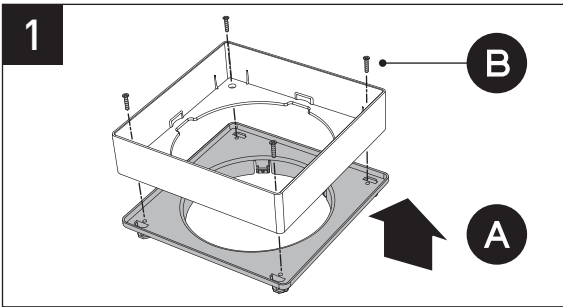

### RECOMMENDED - Attach Poured Deck Skimmer Collar\*\*

- Assemble Adapter to underside of Outer Frame (A).
- Fasten in place using Screws provided (B).

**HAND TIGHTEN ONLY - DO NOT USE POWER TOOLS.**

**DO NOT OVERTIGHTEN SCREWS AS THIS CAN CAUSE DAMAGE TO PLASTIC PART.**

\*\* Poured Deck Skimmer Collar sold separately. (P/N: 475-243)

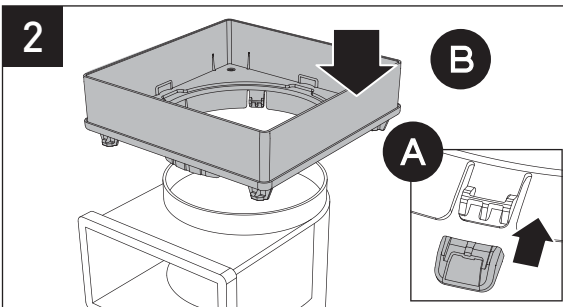

To locate Outer Frame on skimmer:

- Check fit of Poured Deck Skimmer Collar **OVER** skimmer opening or extension collar. The six springs should flex slightly for correct fitment to skimmer. If required, attach Caps to end of springs to remove excess clearance (A).
- Slide Outer Frame with adapter over top skimmer opening as shown (B).

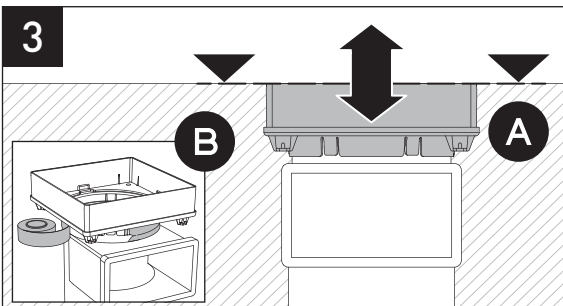

To correctly position Outer Frame:

- Ensure height and position of Outer Frame is level, square and top surface matches finished concrete height (A).
- Secure Outer Frame into position with appropriate tape or equivalent (B).

**ENSURE ATTACHMENT IS SEALED TO PREVENT CONCRETE ENTERING SKIMMER.**

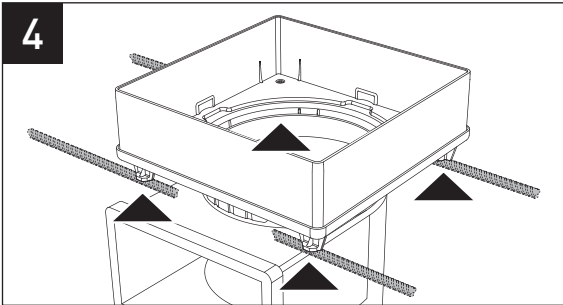

To support Outer Frame:

- Provide additional reinforcing and support as required to prevent Outer Frame moving during concreting process.

**ENSURE SUPPORT DOES NOT COMPROMISE INTEGRITY OF SURROUNDING CONCRETE STRUCTURE**

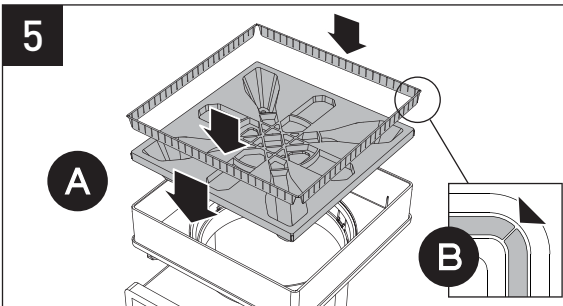

To prepare Outer Frame for concrete:

- **RECOMMENDED** - Insert M60 V-GUARD\*\* and red Construction Spacers into Outer Frame (A).
- Ensure top of red Construction Spacers are flush with surrounding rim and corners are correctly aligned (B).

\*\* M60 V-GUARD sold separately.  
(P/N: 475-4104)

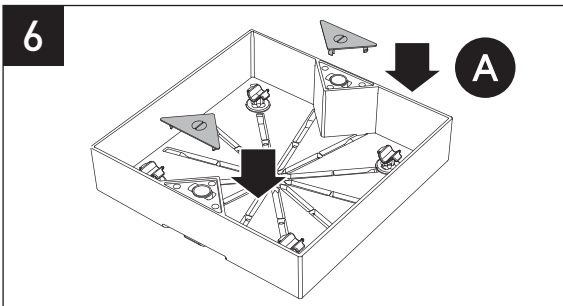

To prepare Lid for concrete:

- Remove Keys.
- Insert red Construction Caps to protect Key openings (A).

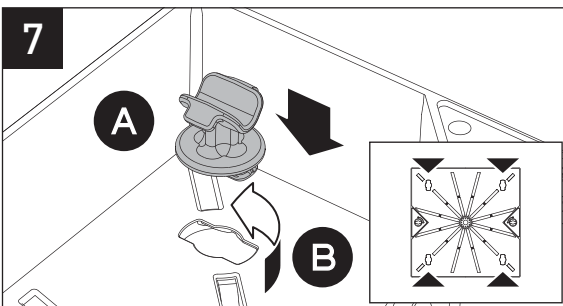

To assemble Concrete Anchors:

- Insert Concrete Anchors into Lid floor (4 places) (A).
- Rotate each Concrete Anchor 90 degrees to lock in place (B).

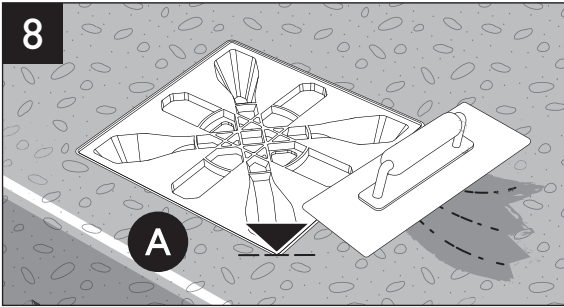

To complete concreting:

- Pour concrete around Outer Frame and remove all voids.
- Check Outer Frame has remained at correct height & position.
- Carefully trowel concrete flush with top rim removing any excess (A). Apply desired finish to concrete.
- Remove M60 V-GUARD & Spacers once concrete has set.

**REMOVE ANY CONCRETE THAT FALLS INTO SKIMMER IMMEDIATELY.**

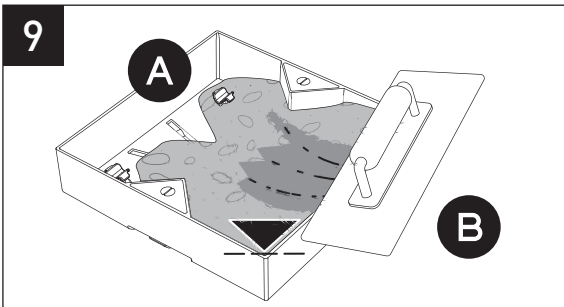

To infill Lid:

- Place Lid on a level and stable surface.
- Pour concrete into Lid and remove all voids (A).
- Carefully trowel concrete flush with top rim removing any excess (B).
- Apply desired finish to concrete.

**ENSURE RED CONSTRUCTION CAPS ARE FULLY VISIBLE BEFORE CONCRETE SETS.**

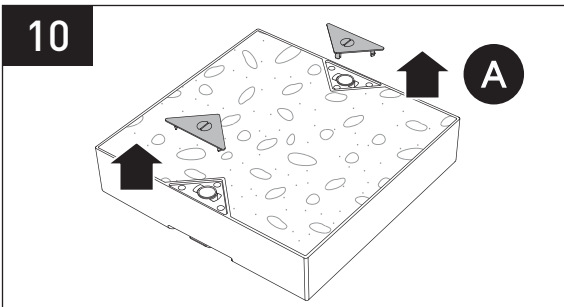

## AFTER CONCRETE HAS SET

To prepare Lid for Trim Plates:

- Remove Construction Caps (A).

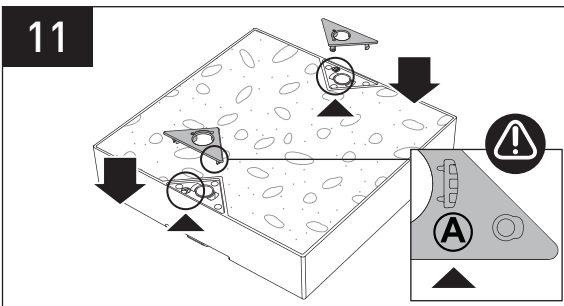

**ENSURE "A" & "B" TRIM PLATES ARE INSERTED INTO CORRECT RECESSES**

To assemble Trim Plates:

- Ensure key openings and surrounding recesses are clean & free from debris.
- Carefully clip Trim Plates into correct recess "A" or "B" as marked.

12

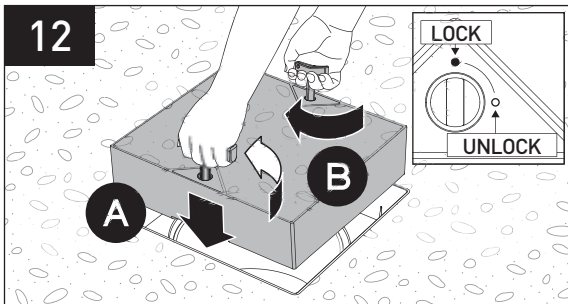

To finish installation:

- Insert Keys into Lid and rotate both into the "Unlocked" position.
- Carefully lower Lid into Outer Frame (A).
- Rotate keys into "Locked" position (B) and remove Keys from Lid.

**STORE KEYS IN SAFE PLACE.  
KEEP KEYS OUT OF REACH OF CHILDREN.**

**SEE "GENERAL USAGE" (PAGE 15)  
FOR CORRECT OPERATION OF LID.**

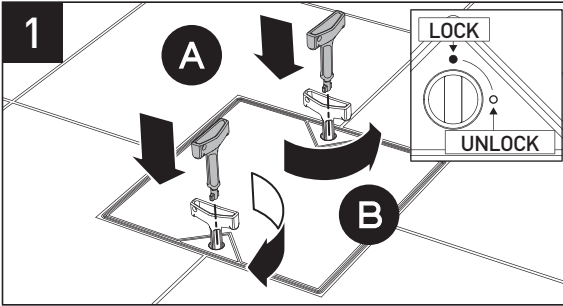

## OPENING LID

To unlock Lid:

- Insert Keys into Lid openings (A).
- Rotate Keys 90 degrees to unlock position (B).
- Keys are now captive in Lid.

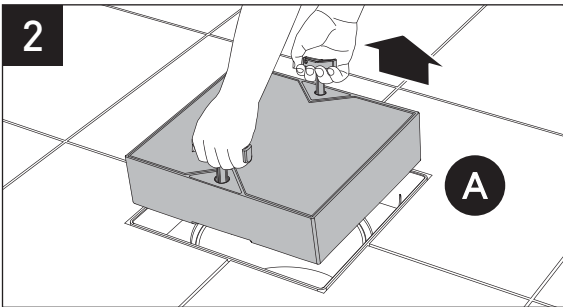

To remove Lid:

- Using Keys as handles lift Lid upwards (A) and remove from Outer Frame.
- Carefully place Lid down next to skimmer opening.



**LID MAY BE HEAVY.  
27 ~ 31 lbs (12 - 14 kgs)  
PLEASE TAKE CARE WHEN  
LIFTING OR SEEK ASSISTANCE.**

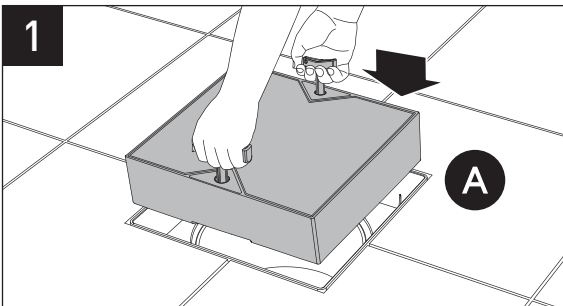

## CLOSING LID

To replace Lid:

- Using Keys as handles, carefully lower Lid into Outer Frame (A).



**LID MAY BE HEAVY.  
27 ~ 31 lbs (12 - 14 kgs)  
PLEASE TAKE CARE WHEN  
LIFTING OR SEEK ASSISTANCE.**

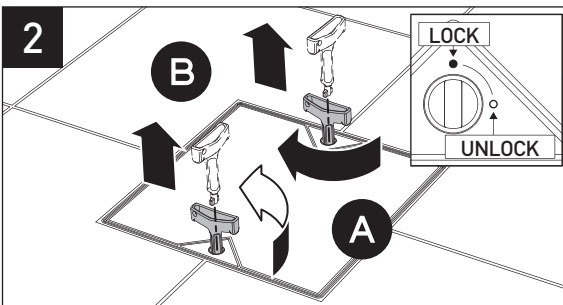

To lock Lid:

- Rotate keys 90 degrees into "Locked" position (A) ensuring latches engage correctly in Outer Frame.
- Remove both Keys from Lid (B).

**STORE KEYS IN SAFE PLACE.  
KEEP KEYS OUT OF REACH OF CHILDREN.**

# M60 - DIMENSIONS | DIMENSIONES\*

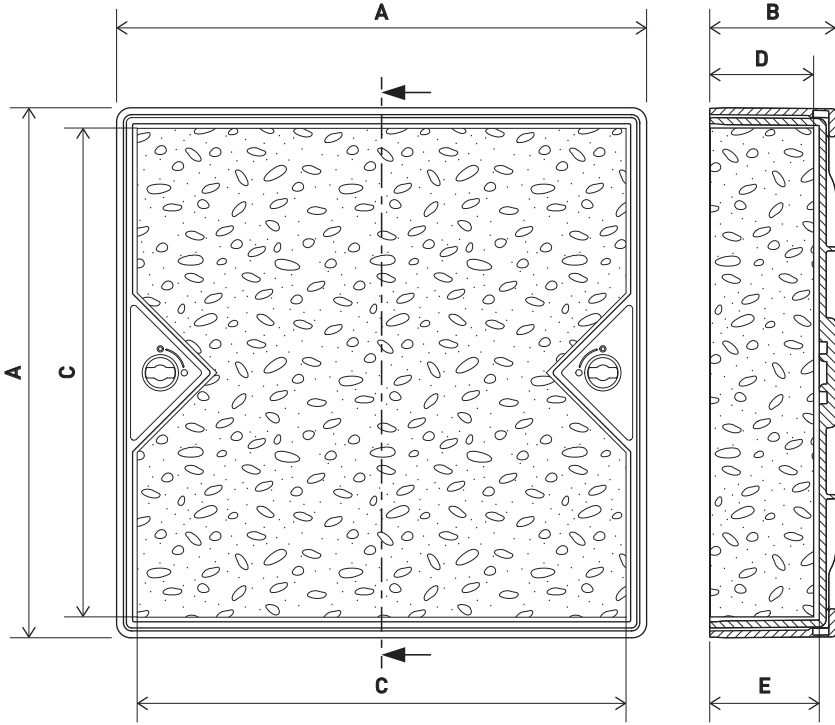

\* Tolerance | Tolérance | Tolerancia: +/- 3/64" (0.0394) in. ( 1.0mm )

	NAME - NOM - NOMBRE	in.   po.		mm.
A	Outer Frame - Overall Size Cadre Extérieur - Taille hors tout Marco exterior - Tamaño total	12"	12.0	305.0
B	Outer Frame - Overall Depth Cadre extérieur - Profondeur hors tout Marco exterior - Profundidad total	2-7/8"	2.874	73.0
C	Paver Inlay - Overall Size <b>CUT PAVER TO THIS SIZE</b> Incrustation de pavé - Taille hors tout <b>COUPER LE PAVÉ À CETTE TAILLE</b> Adoquín de revestimiento - Tamaño total <b>ADOQUÍN CORTADO A ESTE TAMAÑO</b>	11-1/16"	11.0625	281.0
D	Paver Inlay - Thickness Range Empiècement de pavé - Gamme d'épaisseur Adoquín de revestimiento - Rango de espesor	2-1/8" - 2-3/8"	2.126 - 2.362	54.0 - 60.0
E	Lid - Internal Depth Couvercle - Profondeur interne Tapa - Profundidad interna	2-1/2"	2.5	63.0

AQUEA (AQUEA Pty. Ltd. AUSTRALIA) grants the following limited warranty to the first person ("the customer") for whom the skimmer lid ("the Product") is installed.

AQUEA warrants that, subject to the exclusions and limitations below, its products will be free from defects in materials and workmanship for a minimum period of 12 MONTHS from the date of installation. If the date of installation cannot be shown, the warranty period will commence from the date of purchase. The provisions of this warranty are not transferable and are only valid in original country of purchase.

If a defect appears in any Product before the end of the Warranty Period due solely to defective materials or workmanship, AQUEA will in its sole discretion replace the Product or the defective part of the Product free of charge.

AQUEA at its sole discretion may replace defective parts of the Products with parts and components of similar quality, grade and composition where an identical part or component is not available. This warranty does not cover any costs related to travel, removal or re-installation associated with repair or replacement of the Product.

## TO MAKE A WARRANTY CLAIM

To claim under this warranty the customer should immediately cease use of the Product once an alleged defect is identified, and contact AQUEA or their authorised representative within 30 days.

To make a claim the customer must:

1. Provide the following information:

- (a) proof of purchase disclosing place of purchase and purchase or installation date;
- (b) a completed Warranty Form providing full details of the alleged defect; and
- (c) any other appropriate documentation.

2. The customer must return the faulty product to AQUEA or its authorised representative for inspection if requested by AQUEA.

3. The customer agrees to pay AQUEA's usual charges (including any service fee) for any goods or services provided by AQUEA not covered by this product warranty.

4. The customer is responsible for the cost of transport and all insurance of the Product to and from AQUEA or its authorised representative.

## WARRANTY CONDITIONS

This warranty only applies where the following conditions are met:

1. The customer complies with the following general maintenance requirements:

- (a) The Product is maintained free from general debris or foreign matter.
- (b) The Product is maintained and serviced regularly (at least every 12 months) by a suitably qualified professional.

2. Where applicable, Product has been used in pool or spa water which:

- (a) is maintained within a pH range of 7.2-7.6, and chemically balanced as per accepted industry standards.
- (b) is regularly (at least once a month) treated with a sanitising system in compliance with applicable regulatory recommendations or regulations.
- (c) has not exceeded 40 degrees Celsius in temperature.

## WARRANTY EXCLUSIONS

This warranty will not apply where:

- (a) the Product has not been installed in accordance with the installation instructions provided with the Product, any statutory requirements and these terms and conditions;
- (b) the Product has not been installed by a suitably qualified professional trained in the installation and operation of such

products with more than 12 months industry experience;

(c) a failure to observe and comply with the instructions supplied with product for the proper use, service or maintenance of the Product has occurred;

(d) the Product has been used for a purpose other than that for which it was designed and manufactured;

(e) removal or installation of the Product has contributed to, or resulted in, the defect or damage;

(f) the Product has been repaired, altered or modified by someone other than AQUEA or its authorised representative;

(g) substitute or replacement parts not provided by AQUEA have been used;

(h) the defect has arisen due to abuse, misuse, neglect, or accident;

(i) the Product has been subject to abnormal conditions or events, including environment, temperature, water, fire, ice or other acts of nature;

(j) the Product has been subject to abnormal corrosive conditions or abrasive chemicals;

(k) the defect is the result of corrosion or normal wear and tear;

(l) the defect is the result of insect and/or vermin infestation;

(m) concrete, cement, render, pebbles or other pool interior/pool deck surface finishes contribute to the defect, or inhibit proper function of the Product;

(n) the damage occurred in transit;

(o) after inspection AQUEA or their authorised representative cannot establish any fault in the Product;

(p) the Product has been used in a commercial application without prior written consent from AQUEA or its authorised representative;

(q) the Product has not been supplied by AQUEA;

(r) the defect is related to any cause other than a defect in the materials or workmanship of the Product.

## LIMITATIONS

AQUEA makes no express warranties or representations other than set out in this warranty.

Except to the extent required by local consumer laws, the replacement of the Product or part of the Product is the absolute limit of AQUEA's liability under this express warranty.

To the extent permitted by law, AQUEA will not be liable for:

(a) Damage to any other property caused by defect in the Product.

(b) Any indirect, special or consequential loss arising from or related to defects in the Product, including, but not limited to, loss of time, loss of use of the product, loss of business opportunity, loss of profits, loss of revenue, loss of goodwill, or inconvenience.

(c) Any other damage as a result of weather or natural disaster.

(d) Personal injury, property damage or economic loss, however caused.

(e) Any claim against the customer by other parties.

This product warranty is offered in addition to any other rights and remedies the customer may have under law that AQUEA cannot exclude.

## CONTACT

To make a claim under this warranty, please contact:

SELECT POOL PRODUCTS

3345 North Service Road #104A, Burlington, ON L7N 3G2, CANADA

WEB: WWW.SELECTPOOLPRODUCTS.CA

TOLL FREE: 1-855-881-0889

# AQUEA

WWW.AQUEAPRODUCTS.COM

**ADDRESS | ADRESSE | DIRECCIÓN**

NORTH AMERICAN OFFICE - SELECT POOL PRODUCTS  
3345 NORTH SERVICE ROAD #104A, BURLINGTON, ON L7N 3G2, CANADA

**SALES & SUPPORT | SOUTIEN AUX VENTES | SOPORTE DE VENTAS**

INFO@SELECTPOOLPRODUCTS.CA

**TELEPHONE | TÉLÉPHONE | TELÉFONO**

1-855-881-0889 | (905) 331-0889