

AQUEA

BUBBLER+



GOLD AWARD
PRODUCT OF
THE YEAR
VICTORIA 2022



GOLD AWARD
NEW PRODUCT
AWARD
VICTORIA 2022



FINALIST
PRODUCT OF
THE YEAR
NATIONAL 2022



FINALIST
NEW PRODUCT
AWARD
NATIONAL 2022



HIGHLY
COMMENDED
INNOVATIVE
PRODUCT
QUEENSLAND 2022



BRING YOUR WATER TO LIFE

THE SIMPLE MODULAR BUBBLER SYSTEM FOR CONCRETE POOLS AND SPAS

BUBBLER+ is the simple and convenient bubbler system for your next concrete pool or spa project.

The modular design gives you the freedom to create the perfect layout for your pool or spa. Use it in seats, foot wells, benches, steps, beach entries, ponds, pool windows – the possibilities are endless!

The unique manifold design provides even spacing between nozzles and can be cut to length to suit specific applications.

Compact, slip-fit nozzles provide a neat and discreet finish and are available in a range of colours to suit your pool interior.

Closely spaced nozzles create a stunningly even spread of bubbles on the water's surface.



Closely spaced nozzles for an even spread of bubbles on water's surface

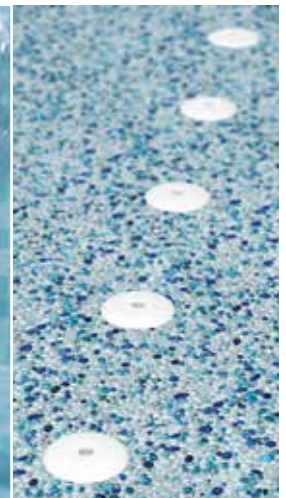

Neat and discreet finish in pool interior

AQUEA PRODUCTS ARE DESIGNED IN AUSTRALIA TO SUIT AUSTRALIAN POOLS

CONVENIENT

The standard kit provides everything you'll need for most projects.

DISCREET FINISH

AQUEA's slip-fit nozzle pushes in securely to conceal riser pipe, tile cuts and pebble edges providing a superior finish every time.

SCALEABLE

Create an air-loop with up to 36 nozzles using standard air blowers.*

KEEP IT CLEAN

Construction Caps keep air-loop clear of concrete, render, grout and debris during construction.

ADAPTABLE

Modify risers or replace with standard pressure pipe if needed. Manifold outlets can be capped for wider spacing if desired.

MODULAR DESIGN

The unique BUBBLER+ manifold allows for virtually unlimited configurations, including; square, rectangular, straight and horseshoe layouts. The manifold is also compatible with 50mm pressure pipe fittings for quick & easy installation.

* Refer to AQUEA Specification sheet for more information.

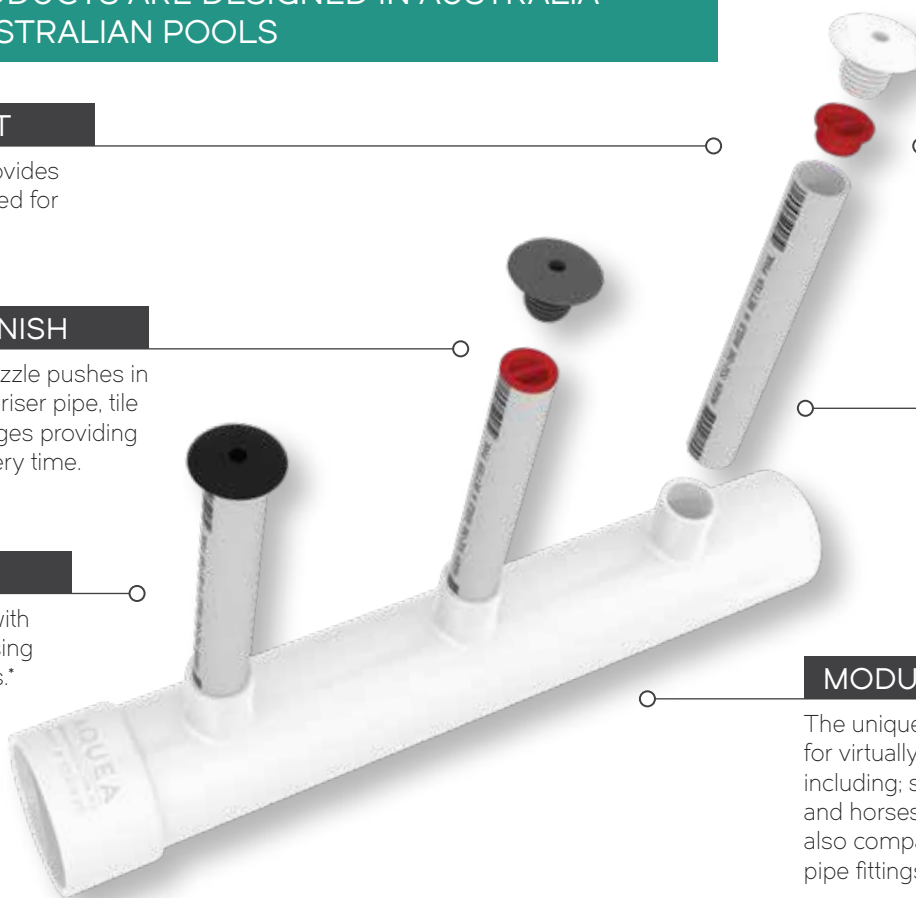

AQUEA

HELLO@AQUEA.COM.AU

WWW.AQUEA.COM.AU

0481 875 870



BUILD A
BETTER
POOL

532-803-05

THE SIMPLE MODULAR BUBBLER SYSTEM FOR CONCRETE POOLS & SPAS

BUBBLER+ is the simple and convenient bubbler system for your next concrete pool or spa project.

The modular design gives you the freedom to create the perfect layout for your pool or spa. Use it in seats, foot wells, benches, steps, beach entries, ponds, pool windows – the possibilities are endless!

KEY FEATURES:

- Compact nozzles provide a neat & discreet finish in a range of colours to suit your pool interior.
- Unique manifold provides even spacing between nozzles and can be cut to length if required.
- Risers compatible with standard pressure pipe or DN20 caps for wider spacing if required.

SPECIFICATIONS

DESCRIPTION	BUBBLER+ 18 Port Kit
KIT COLOUR OPTIONS (Nozzle colour)	<input type="checkbox"/> White - Part No.: 532-250 <input type="checkbox"/> Light Grey - Part No.: 532-256 <input type="checkbox"/> Grey - Part No.: 532-253 <input type="checkbox"/> Black - Part No.: 532-254
POOL TYPE	Suits concrete pools
MATERIAL	ABS - Manifold PVC - Riser PP - Nozzle & Construction Cap
COMPATIBLE PIPE SIZE	Body - DN50 Class 12 Riser - DN15 Class 18
KIT CONTENTS	Manifold (x 6) Riser (x 18) Nozzle (x 18) Construction Cap (x 18)
SPARE NOZZLES (18 Nozzles per bag)	<input type="checkbox"/> White - Part No.: 532-403 <input type="checkbox"/> Light Grey - Part No.: 532-406 <input type="checkbox"/> Grey - Part No.: 532-404 <input type="checkbox"/> Black - Part No.: 532-405



MAXIMUM RECOMMENDED PORTS

WATER DEPTH	PORTS (MAX.)*
Up to 500 mm	36
500 ~ 1000 mm	27
Over 1000 mm	Installer to determine maximum nozzles according to specific site requirements & water depth.

* Figures based on testing with Spa-King 1.5hp "Peacemaker" blower. Installer to ensure equivalent blower is used when referencing figures.

All dimensions in mm

KEY DIMENSIONS

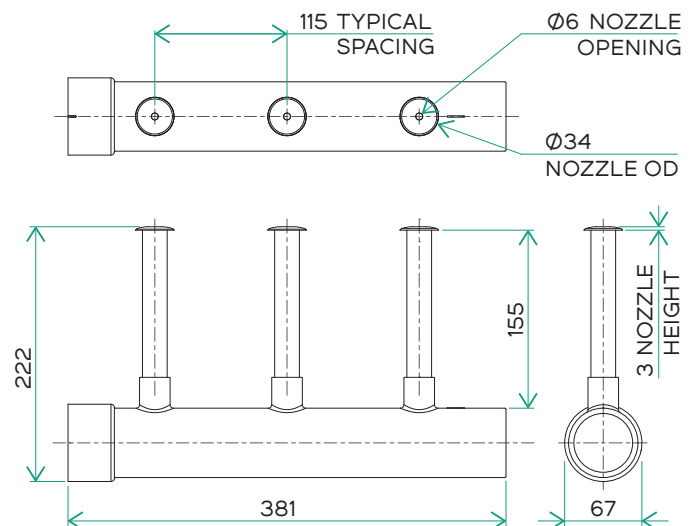

Specifications subject to change without notice.



WANT MORE INFORMATION?

Scan this code to watch our series of helpful BUBBLER+ videos.

AQUEA® is a registered trademark of AQUEA Pty. Ltd.

The contents of this document are the exclusive copyright of AQUEA® and may not be reproduced without written permission. © 2025

Whilst every care was taken in preparation of this document, AQUEA® accepts no responsibility for the accuracy of the information supplied.

532-819-03



ADDITIONAL INFORMATION FOR RESELLERS, BUILDERS & PLUMBERS

This guide has been prepared in association with **Spa King Blower Co.**

AQUEA recommend Spa King **Peacemaker** and **Burial blowers** for their class-leading performance, reliability and self-cooling functionality.

Please read this guide in conjunction with AQUEA's BUBBLER+ Installation Manual # 532-802, Product Specification # 532-819 and your preferred blower's installation guide and specifications.

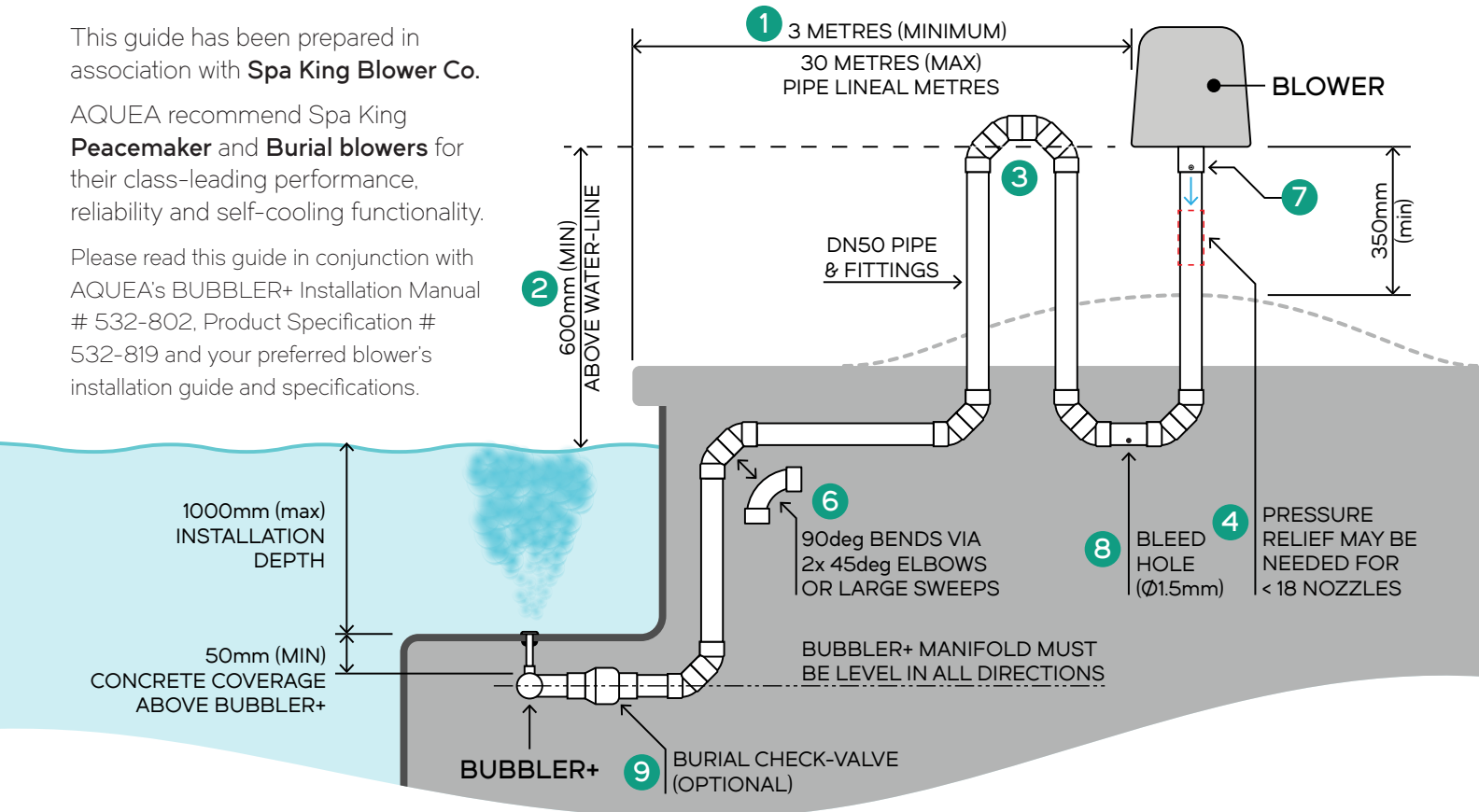

INSTALLATION NOTES:

- 1 Install **SPA KING** blowers over 3 metres but not more than 30 metres from the pool or spa. Blower should be at least 350mm above ground-level.
- 2 Install blower at least 600mm above water-line.
- 3 Always install a 600mm-high air-loop between blower and water, as close to the pool / spa as practical.
- 4 **SPA KING** recommends a minimum of 18 x BUBBLER+ nozzles are installed with their **PEACEMAKER** and **BURIAL** blowers, and a maximum of 36 nozzles at 500mm below water-line. If fewer than 18 nozzles are used, a pressure-relief device may be required.
- 5 The recommended maximum linear-length of submerged air-line (below water-line) is 12 metres – including BUBBLER+ fittings, pipes, joiners, elbows and sweeps.
- 6 Any changes in pipe direction should use 2 x 45 degree elbow couplings and/or large 90 degree sweep.
- 7 Do not glue air-feed pipes to the blower. Use screw(s) supplied with your **SPA KING** blower to retain air-feed pipes.
- 8 To prevent condensation build-up in the air-supply line between the blower and air-loop, a small drainage hole can be drilled at the pipe's lowest point.
- 9 [Optional] For reduced initial pressure and faster start-up, a spring-less burial check valve can be installed between the air-loop and blower.

AQUEA® is a registered trademark of AQUEA Pty. Ltd.

The contents of this document are the exclusive copyright of AQUEA® and may not be reproduced without written permission. © 2025

Whilst every care was taken in preparation of this document, AQUEA® or SPA KING BLOWER CO. accepts no responsibility for the accuracy of the information supplied.

Information and specifications may change without notice.

532-829-02

ADDITIONAL INFORMATION FOR RESELLERS, BUILDERS & PLUMBERS

CONFIGURATIONS & ASSEMBLY:

BUBBLER+ can be installed in almost infinite shapes and configurations, including square, rectangle, straight and U-shaped manifolds.

Subject to your preferred blower's specifications and correct manifold installation, air-feed lines can be positioned anywhere within the BUBBLER+ manifold, including via a central "tee" inlet, corner or from the end of a straight-line (see blue arrows in diagrams below).

Ensure the BUBBLER+ air-line is level in all directions and your blower can produce sufficient initial air-pressure to purge water from submerged pipework.

Air bubbles should equalise soon after activation.

INSTALLATION EXAMPLES:

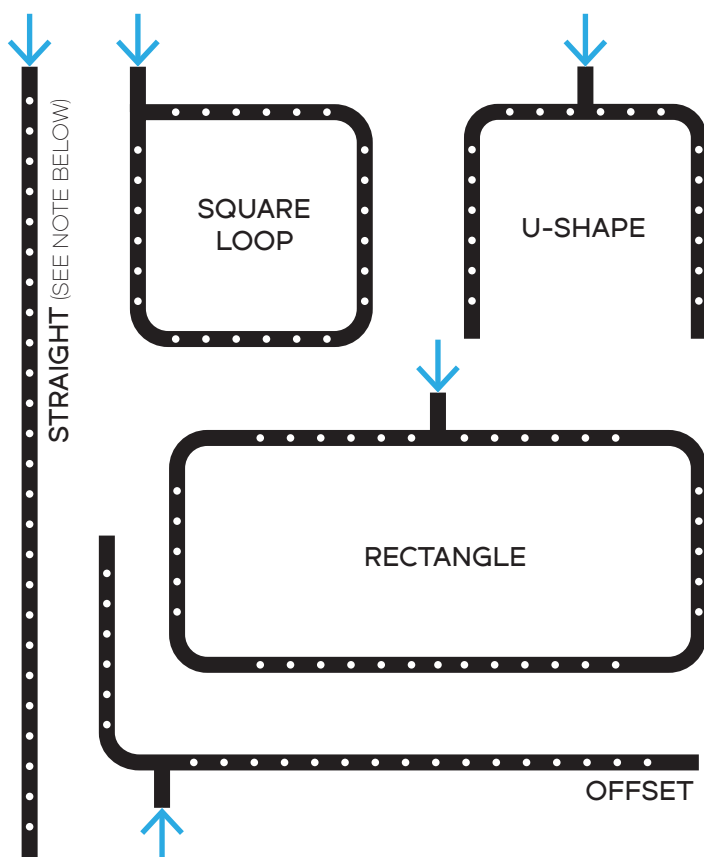

STRAIGHT LINE INSTALLATIONS:

Recommended maximum linear length for straight-line installations (as drawn above) = 6 metres @ 500mm depth below water-line.

GENERAL NOTES:

BUBBLER+ is intended for use with air-blowers that are designed and installed in accordance with all applicable standards, regulations and safety requirements.

Blowers must be installed in accordance with manufacturer specifications. Blower manufacturer specifications take precedence over this guide.

Unless otherwise instructed, blowers must be installed with an earth leakage protection circuit (GFCI) or RCD (Residual Current Device).

Blower power supply must be waterproof.

Air-feed lines passing through walls should be installed with a rubber coupling to isolate the blower from the wall and insulate against minor vibration and noise.

ABS-compatible solvent cement should be used to bond BUBBLER+ and associated plumbing components together. Non-pressure (N-type) PVC solvent adhesive may also be used. Fittings must be clean, dry and free of dust, oils and any other contaminants prior to jointing. Apply solvent adhesive liberally to ensure strong and sealed joints.

BUBBLER+ manifolds must be installed level in all directions to ensure balanced air-output.

For installations exceeding 1 metre depth, seek advice from a qualified engineer to ensure your bubbler system is designed for optimal performance.

BLOWER SPECIFICATIONS* (REFERENCE ONLY)

SPA KING MODEL	XTA	PEACEMAKER	BURIAL
Wattage	1000	1100	1100
Maximum flow**	3078 lpm	2910	2910
Amps	7	7	7
Pipe Ø	DN50	DN50	DN50
Minimum nozzles**	18	18	18
Maximum nozzles**	36	36	36

* Blower specifications above are for reference only and subject to change without notice. Seek advice from the manufacturer of your preferred blower to confirm optimal design & configuration for your BUBBLER+ system.

** Maximum flow based on blower-system operating load of 27 kPa when nozzles installed 500mm below water-line.

532-829-02

AQUEA

BUBBLER+

INSTALLATION GUIDE

(PART NO. 532-250)

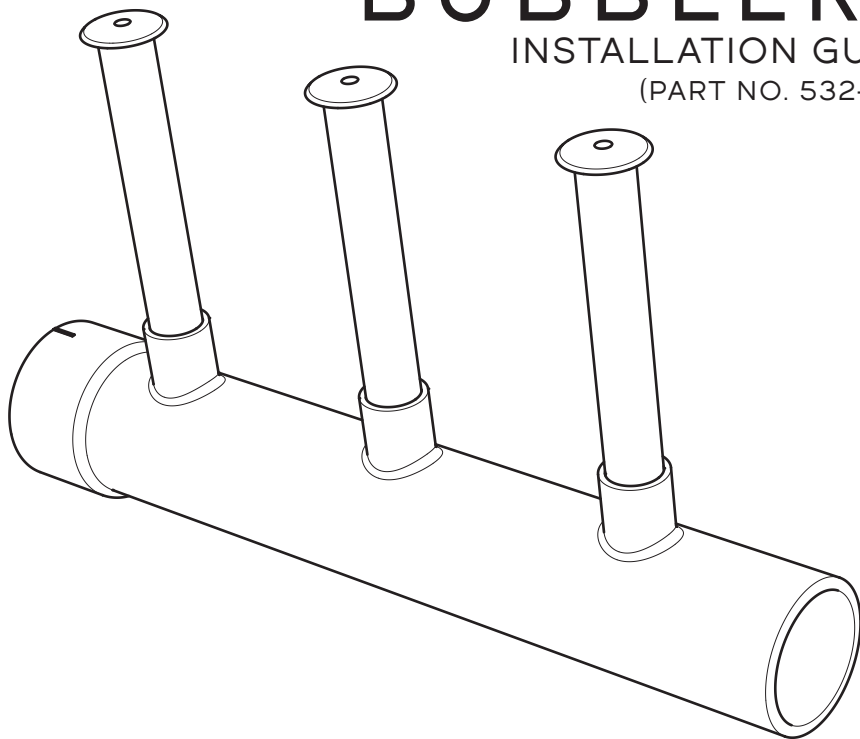

NOTE:

1. READ THIS DOCUMENT PRIOR TO INSTALLATION. IMPROPER INSTALLATION WILL VOID WARRANTY.
2. PRODUCT MUST BE INSTALLED & SERVICED BY A QUALIFIED PROFESSIONAL.
3. MANIFOLD (PART 532-420) MANUFACTURED FROM ABS. INSTALLER MUST CONFIRM JOINTING COMPOUND IS COMPATIBLE WITH ABS BEFORE USE.
4. INSTALLER TO ENSURE INSTALLATION MEETS ALL APPLICABLE ENGINEERING & REGULATORY REQUIREMENTS.
5. THIS MANUAL CONTAINS IMPORTANT INFORMATION AND SHOULD BE STORED IN A SAFE PLACE AFTER INSTALLATION.

AQUEA® - U12, 22-24 REDLAND DRIVE, MITCHAM, VICTORIA 3132.

PRODUCT SUPPORT - HELLO@AQUEA.COM.AU **PHONE** - 0481 875 870

INSTALLATION TIPS

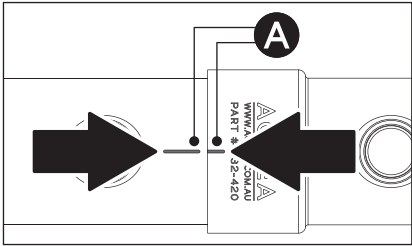

Align marks (A) when joining Manifolds to ensure Risers are correctly aligned.

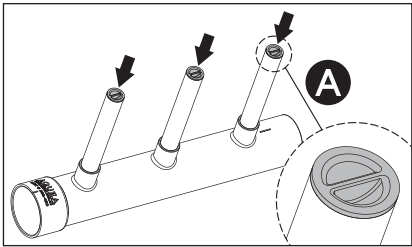

Keep Construction Caps in Risers (A) so Manifold remains clear of debris during construction.

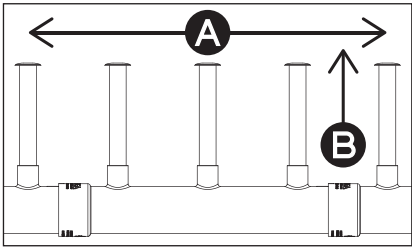

Ensure Manifold and Risers are secured level (A) and plumb (B) as necessary to suit installation site requirements.

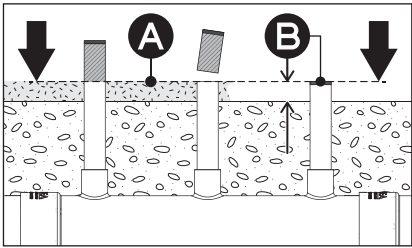

(A) **Tile:** Trim Risers flush when tiling is complete.

(B) **Pebble:** Trim Risers, allowing for pebble thickness. Insert Caps before pebbling.

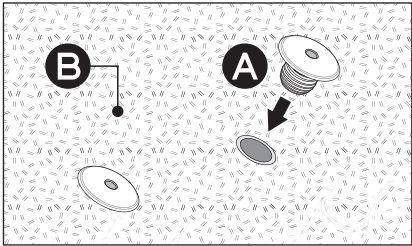

Insert Nozzles (A) into Risers firmly against interior finish (B). **ADHESIVE OR SILICONE IS NOT REQUIRED.**

⚠ PLEASE NOTE:

1. BUBBLER+ air-loops can be installed in closed-loop, straight-line and horseshoe configurations.
 2. Apply full & even coverage of ABS-compatible solvent cement to ensure strong and water-tight connections.
 3. BUBBLER+ feed-line can be located anywhere within the nozzle array. Scan QR code below for more information.
 4. Install and connect blower in accordance with manufacturer instructions and safety requirements.
 5. Maximum recommended nozzles & depths*:
- | Water Depth | Nozzles (max) |
|--------------|---------------|
| Up to 500mm | 36 |
| Up to 1000mm | 27 |
| Over 1000mm | Note 6 |
6. Builder / Installer to determine maximum nozzles according to specific site requirements and water depth.
 7. Contact your pool pre-plumb stockist for recommended air equipment to suit your project.

* Figures stated based on testing with Spa-King 1100W "Peacemaker" blower.



Scan for more information and BUBBLER+ technical specifications.

The contents of this manual are the exclusive copyright of AQUEA® and may not be reproduced without written permission. © 2025

Whilst every care was taken in preparation of this document, AQUEA® accepts no responsibility for the accuracy of the information supplied.

KIT CONTENTS

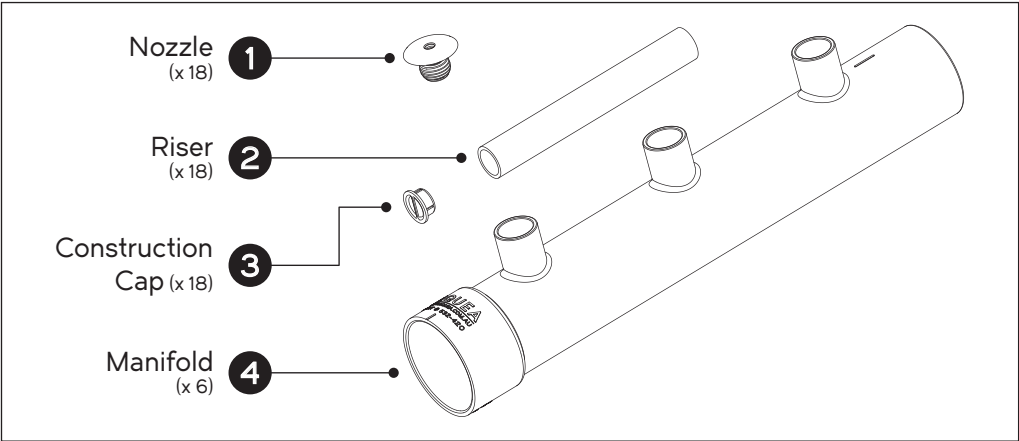

TYPICAL INSTALLATION

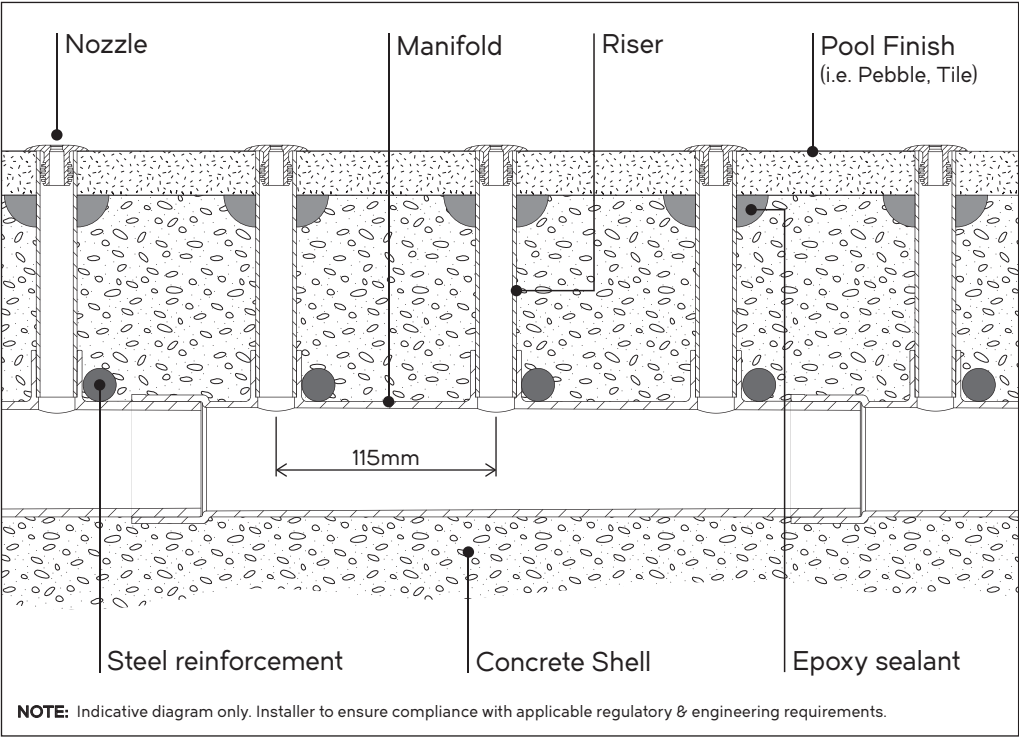

Registered Design. Specifications subject to change without notice.

Ref: 532-802-02

AQUEA® is a registered trademark of AQUEA Pty. Ltd.

WARRANTY POLICY

AQUEA (a division of AQUEA Pty. Ltd.) warrants that, subject to the exclusions and limitations below, its products will be free from defects in materials and workmanship for a minimum period of 12 MONTHS from the date of purchase. All warranty periods commence on the date of purchase by the customer and are only valid in original country of purchase. The provisions of this warranty are not transferable.

If a defect appears in any Product supplied by AQUEA before the end of the Warranty Period due solely to defective materials or workmanship, AQUEA will in its sole discretion, and subject to these terms and conditions, either:

- a) repair the Product or the defective part of the Product free of charge; or
- b) have the Product or the defective part of the Product repaired by a qualified repairer free of charge; or
- c) replace the Product.

AQUEA at its sole discretion may replace defective parts of the Products with parts and components of similar quality, grade and composition where an identical part or component is not available. Refurbished parts may be used to repair the Products.

All repairs are to be carried out by AQUEA or its authorised repairer only. This warranty does not cover any costs related to travel, removal or re-installation associated with repair or replacement of the Product.

TO MAKE A WARRANTY CLAIM

To claim under this warranty the customer should immediately cease use of the Product once alleged defect is identified, and contact AQUEA within 30 days.

To make a claim the customer must:

1. Provide the following information:

- (a) proof of purchase disclosing date and place of purchase;
- (b) full details of the alleged defect; and
- (c) any other appropriate documentation.

2. The customer must make the Product or site available to AQUEA or its authorised repair agent for inspection and testing. If such inspection and testing finds no defect in the Product, the customer must pay AQUEA's usual costs of service work and testing.

3. The customer agrees to pay AQUEA's usual charges (including any service fee) for any goods or services provided by AQUEA not covered by this product warranty.

4. The customer is responsible for the cost of transport and all insurance of the Product to and from AQUEA or its authorised repair agent.

WARRANTY CONDITIONS

This warranty only applies where the following conditions are met:

1. The customer complies with the following general maintenance requirements:

- (a) The Product is maintained free from general debris or foreign matter.
- (b) The Product is maintained and serviced regularly (at least every 12 months) by a suitably qualified professional.
- (c) Where applicable, the Product is replaced at specified intervals as outlined in product literature by AQUEA.

2. Where applicable, Product has been used in pool or spa water which:

- (a) is maintained within a pH range of 7.2-7.6, and chemically balanced as per accepted industry standards.
- (b) is regularly (at least once a month) treated with a sanitising system in compliance with applicable regulatory recommendations or regulations.
- (c) has not exceeded 40 degrees Celsius in temperature.
- (d) has not been exposed to freezing conditions.

WARRANTY EXCLUSIONS

This warranty will not apply where:

- (a) the Product has not been installed in accordance with the installation instructions provided with the Product, any statutory requirements and these terms and conditions;
- (b) the Product has not been installed by a suitably qualified professional trained in the installation and operation of such products with more than 12 months industry experience;
- (c) a failure to observe and comply with the instructions supplied with product for the proper use, service or maintenance of the Product has occurred;
- (d) the Product has been used for a purpose other than that for which it was designed and manufactured;
- (e) removal or installation of the Product has contributed to, or resulted in, the defect or damage;
- (f) the Product has been repaired, altered or modified by someone other than AQUEA or its authorised agent;
- (g) substitute or replacement parts not provided by AQUEA have been used;
- (h) the defect has arisen due to abuse, misuse, neglect, or accident;
- (i) the Product has been subject to abnormal conditions, including environment, temperature, water, fire or other acts of nature;
- (j) the Product has been subject to abnormal corrosive conditions or abrasive chemicals;
- (k) the defect is the result of corrosion or normal wear and tear;
- (l) the defect is the result of insect and/or vermin infestation;
- (m) concrete, cement, render, pebbles or other pool surface finishes contribute to the defect, or inhibit proper function of the Product;
- (n) the damage occurred in transit;
- (o) after testing and inspection AQUEA cannot establish any fault in the Product;
- (p) the Product has been used in a commercial application;
- (q) the Product has not been supplied by AQUEA;
- (r) the defect is related to any cause other than a defect in the materials or workmanship of the Product.

LIMITATIONS

AQUEA makes no express warranties or representations other than set out in this warranty.

Except to the extent required by the Australian Consumer Law, the repair or replacement of the Product or part of the Product is the absolute limit of AQUEA's liability under this express warranty.

To the extent permitted by law, AQUEA will not be liable for:

- (a) Damage to any other property caused by defect in the Product.
- (b) Any indirect, special or consequential loss arising from or related to defects in the Product, including, but not limited to, loss of time, loss of use of the product, loss of business opportunity, loss of profits, loss of revenue, loss of goodwill, or inconvenience.
- (c) Any other damage as a result of weather or natural disaster.
- (d) Any claim against the customer by other parties.

Our goods come with guarantees that cannot be excluded under the Australian Consumer Law. You are entitled to a replacement or refund for a major failure and for compensation for any other reasonably foreseeable loss or damage. You are also entitled to have the goods repaired or replaced if the goods fail to be of acceptable quality and the failure does not amount to a major failure.

The benefits of this warranty are in addition to any rights and remedies imposed by Australian State and Federal legislation that cannot be excluded. Nothing in this warranty is to be interpreted as excluding, restricting or modifying any State or Federal legislation applicable to the supply of goods and services which cannot be excluded, restricted or modified.

CONTACT

For warranty claims visit www.aquea.com.au or contact AQUEA using details overleaf.

(Policy Revision 04)